

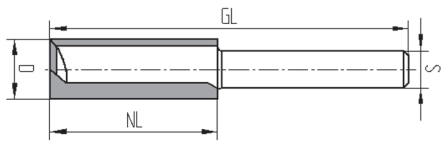

two straight cutting edges • RH rotation •  
parallel shank 10 mm



for use on portable and stationary routers  
with manual feed (MAN)

for plastic, softwood and hardwood

HS	D	NL	GL	Z	S	Part number RH
	5	15	60	2	10	6105.050.000.HS.R
	6	15	60	2	10	6105.060.000.HS.R
	8	30	70	2	10	6105.080.000.HS.R
	13	40	75	2	10	6105.130.000.HS.R
	14	60	90	2	10	6105.140.600.HS.R
	18	15	57	2	10	6105.180.150.HS.R
	19	40	75	2	10	6105.190.000.HS.R
	20	40	75	2	10	6105.200.000.HS.R
	24	15	57	2	10	6105.240.150.HS.R

for hardwood, wood composites and coated materials • with TC-fitted plunge tip

TC	D	NL	GL	Z	S	Part number RH
	4	10	49	2	10	6105.040.000.HW.R
	8	20	60	2	10	6105.080.000.HW.R
	16	15	57	2	10	6105.160.150.HW.R
	20	25	70	2	10	6105.200.000.HW.R
	22	15	57	2	10	6105.220.150.HW.R
	22	25	70	2	10	6105.220.000.HW.R
	25	25	70	2	10	6105.250.000.HW.R

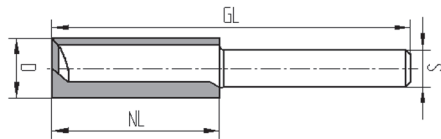

two straight cutting edges • RH rotation •  
parallel shank 10 mm

for use on portable and stationary routers  
with manual feed (MAN)

for plastic, softwood and hardwood

HS	D	NL	GL	Z	S	Part number RH
	15	42	87	2	10	6106.150.000.HS.R

for hardwood, wood composites and coated materials • with TC-fitted plunge tip

TC	D	NL	GL	Z	S	Part number RH
	10	35	87	2	10	6106.100.000.HW.R
	12	35	87	2	10	6106.120.000.HW.R
	14	35	87	2	10	6106.140.000.HW.R

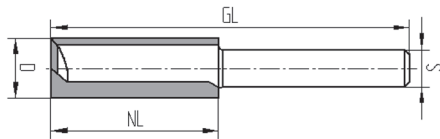

two straight cutting edges • RH or LH rotation •  
parallel shank 10 mm

for use on portable and stationary routers  
with manual feed (MAN)

for plastic, softwood and hardwood

HS	D	NL	GL	Z	S	Part number	Part number
						LH	RH
	10	40	97	2	10	6107.100.000.HS.L	-
	10	50	100	2	10	-	6107.1050.0010.HS.R
	20	48	97	2	10	-	6107.200.000.HS.R

for hardwood, wood composites and coated materials • with TC-fitted plunge tip

TC	D	NL	GL	Z	S	Part number	Part number
						LH	RH
	11	40	97	2	10	-	6107.110.000.HW.R
	17	45	97	2	10	-	6107.170.000.HW.R
	18	45	97	2	10	-	6107.180.000.HW.R