

Shank-mounted tools in HS and TC for machining wood, plastic and aluminium

NAPOLEON
WERKZEUGE

Reese + Fischer GmbH + Co. KG

*Our
Highlights*

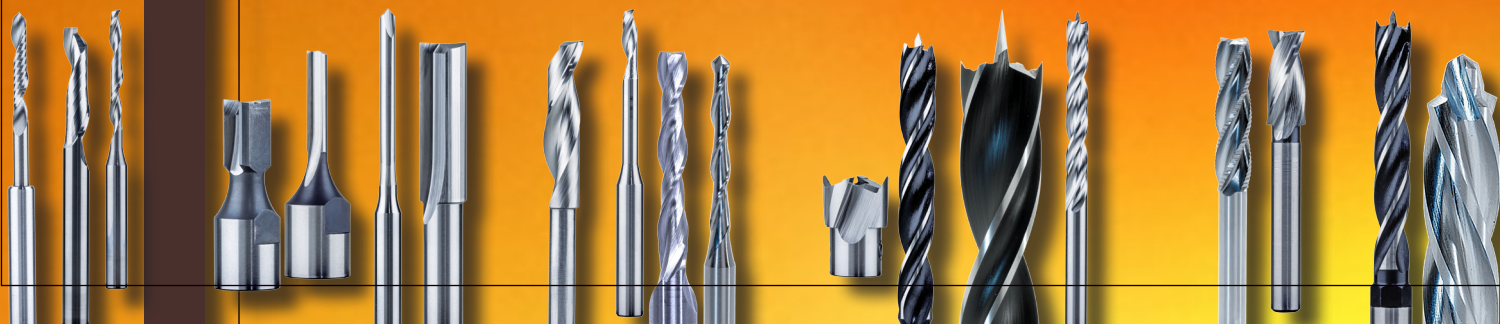

About us

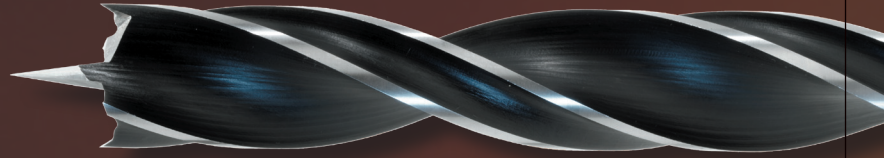

Everything started in 1961...

...first as a contract turnery in the parental home in Oberkochen, founded by Reinhold and Karl Fischer, master mechanical engineer and master turner, and then gradually growing so as to offer its own production for the manufacture of shank-mounted tools for machining wood, plastic and aluminium.

In order to meet the increased need for space, the business moved to the newly constructed company building in Aalen-Niesitz in 1971.

For more than 50 years now in its second generation, precision tools in HS and TC for professional trade and industrial applications have been manufactured here under the registered brand name



and sold mainly in Germany and Europe but also worldwide.

The use of most different machinery and machinery elements and the processing of plastics, aluminium, highly diverse types of wood and materials that have little to do with the original wood material require the tool to be of the highest quality and constantly enhanced, customised for demanding applications.

All production steps from the raw material to the ready-to-sell tool have always been carried out in-house. Only the heat treatment is performed externally by regional partners.

We source our raw materials exclusively from Germany and other EU countries and pay strict attention to compliance with our quality requirements here as well.

Needless to say, our tools meet the requirements of the trade association and the standards of national and European associations.

We also care much about our environment, so we are constantly working to further minimise resource consumption and our ecological footprint.

The name NAPOLEON is well known, and as our estimated customers always assure us, stands for quality, services and dependability „Made in Germany“.

We continue to adhere to the principle:
We don't seek to be one of the largest but would like to be one of the best in terms of quality and commitment.

The whole NAPOLEON team is happy to be there for you!

Reese + Fischer GmbH + Co. KG
NAPOLEON-WERKZEUGE



...simply top!



TABLE OF CONTENTS

About us I

List of Abbreviations 2

Drilling tools 3

- COUNTERSINK
- DOWEL DRILL
- HANDLE DRILL
- STOCKADE DRILL
- TWIST DRILL

Milling tools 13

- GROOVING CUTTER
- LOCKSET CUTTER
- MILLING CUTTER
- ROUGHING CUTTER
- SINGLE FLUTE CUTTER
- WATER SLOT CUTTER

Alphabetical Index 37

Numerical Index 38

GTC II

ABBREVIATIONS • SYMBOLS

α	angle in °
AB	guide pin
AG	external thread
AL	adjusting length
AR	guide ring
AZ	guide pin
B	width
d	diameter • inner diameter • bore
D	diameter
DF	V-point
E	length adjusting screw
GL	total length
HS	high alloy high speed steel
HW	tungsten carbide
IG	internal thread
K	cone
KL	ball bearing
L	length
LD	left spiral
LH	left-hand rotation
li	left-hand rotation
LL	left cut
M	metric thread
MAN	manual feed
MEC	mechanical feed
n	revolutions per minute
NB	ream
NL	working length
P	register
PU	packing unit
r	radius
RD	right spiral
re	right-hand rotation
RH	right-hand rotation
RL	right cut
RPM	revolutions per minute
S	shank
SFI	driving flat
SL	length of shank
SP	high alloy tool steel
STC	solid tungsten carbide
SW	spanner size
TC	tungsten carbide
TiAlN	titanium aluminium nitride
TiN	titanium nitride
TS	high alloy tool steel
U	revolutions
UPVC	unplasticized polyvinyl chloride = hard type of plastic
V	spur
VB	pilot
VE	packing unit
VHW	solid tungsten carbide
Z	number of teeth
Zsp.	center point
zyl.	cylindrical

205

TWIST DRILL

- HS
- two cutting edges
- center point and spurs
- landed flute
- RH rotation
- common shank and drilling diameter

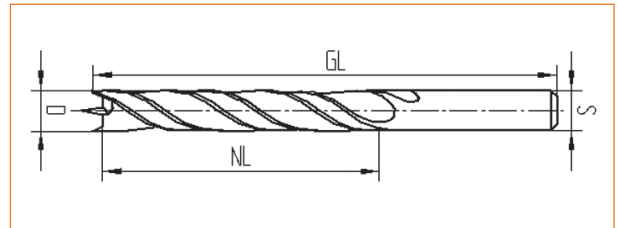

especially for drilling precise blind holes and through holes in soft- and hardwood on portable boring machines etc.

D	NL	GL	S	Z	HS	TC	RH	LH	Part number
5,5	60	95	5,5	2	•		•		205.055.000.HS.R
6	65	100	6	2	•		•		205.060.000.HS.R
7	70	110	7	2	•		•		205.070.000.HS.R
7,5	75	115	7,5	2	•		•		205.075.000.HS.R
8	75	120	8	2	•		•		205.080.000.HS.R
10	90	140	10	2	•		•		205.100.000.HS.R
11	95	150	11	2	•		•		205.110.000.HS.R
12	100	155	12	2	•		•		205.120.000.HS.R

210

TWIST DRILL

- HS
- two cutting edges
- center point and spurs
- landed flute
- RH rotation
- stepped parallel shank 10 mm

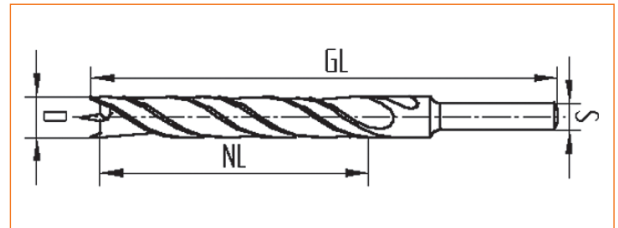

especially for drilling precise holes in soft- and hardwood on portable boring machines etc.

D	NL	GL	S	SL	Z	HS	TC	RH	LH	Part number
11	100	140	10	30	2	•		•		210.110.000.HS.R
12	100	140	10	30	2	•		•		210.120.000.HS.R
13	100	140	10	30	2	•		•		210.130.000.HS.R
14	100	140	10	30	2	•		•		210.140.000.HS.R
15	100	140	10	30	2	•		•		210.150.000.HS.R
16	100	140	10	30	2	•		•		210.160.000.HS.R
18	100	140	10	30	2	•		•		210.180.000.HS.R
20	100	140	10	30	2	•		•		210.200.000.HS.R

213

TWIST DRILL

- HS
- two cutting edges
- center point and spurs
- landed flute
- RH rotation
- stepped parallel shank

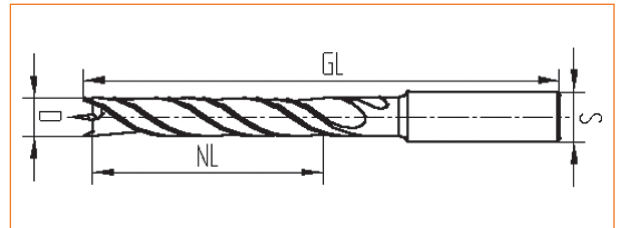

especially for drilling precise holes in soft- and hardwood on portable and upright boring machines etc.

D	NL	GL	S	SL	Z	HS	TC	RH	LH	Part number
6	75	140	13	50	2	•		•		213.060.000.HS.R
8	85	150	13	50	2	•		•		213.080.000.HS.R
10	95	160	13	50	2	•		•		213.100.000.HS.R
11	100	165	13	50	2	•		•		213.110.000.HS.R
12	105	170	13	50	2	•		•		213.120.000.HS.R
13	110	175	13	50	2	•		•		213.130.000.HS.R
14	115	180	13	50	2	•		•		213.140.000.HS.R
15	120	185	13	50	2	•		•		213.150.000.HS.R
16	125	190	16	50	2	•		•		213.160.000.HS.R
18	130	200	16	50	2	•		•		213.180.000.HS.R
20	140	210	16	50	2	•		•		213.200.000.HS.R
22	150	220	16	50	2	•		•		213.220.000.HS.R
24	160	235	16	50	2	•		•		213.240.000.HS.R
25	170	250	20	50	2	•		•		213.250.000.HS.R
26	170	250	20	50	2	•		•		213.260.000.HS.R
28	180	260	20	50	2	•		•		213.280.000.HS.R
30	190	270	20	50	2	•		•		213.300.000.HS.R

215

STOCKADE DRILL

- HS
- two cutting edges
- extra long center point and spurs
- landed flute
- RH rotation
- stepped parallel shank

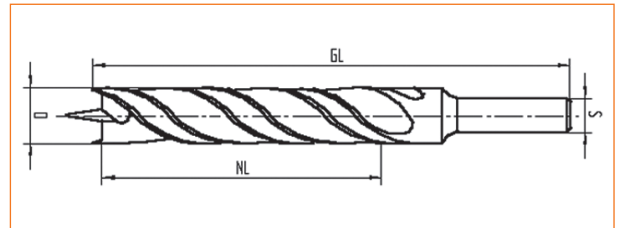

especially for precise inclined drilling (stockade holes) in soft- and hardwood in stair production etc. on drilling attachments for stockade holes e. g. Bohrfix • Bohrluchs

other dimensions also available

D	NL	GL	S	SL	Z	HS	TC	RH	LH	Part number
10	95	160	13	50	2	•		•		215.100.130.HS.R
12	105	170	13	50	2	•		•		215.120.130.HS.R
13	110	175	13	50	2	•		•		215.130.130.HS.R
14	115	180	13	50	2	•		•		215.140.130.HS.R
15	120	185	13	50	2	•		•		215.150.130.HS.R
16	125	190	13	50	2	•		•		215.160.130.HS.R
18	130	200	13	50	2	•		•		215.180.130.HS.R
20	140	210	13	50	2	•		•		215.200.130.HS.R
22	150	220	13	50	2	•		•		215.220.130.HS.R
24	160	235	13	50	2	•		•		215.240.130.HS.R
25	170	250	13	50	2	•		•		215.250.130.HS.R
26	170	250	13	50	2	•		•		215.260.130.HS.R
28	170	250	13	50	2	•		•		215.280.130.HS.R
30	170	250	13	50	2	•		•		215.300.130.HS.R

390

LOOSE COUNTERSINK

- HS
- two cutting edges
- countersink angle 180°
- RH rotation
- bore and crampling screw

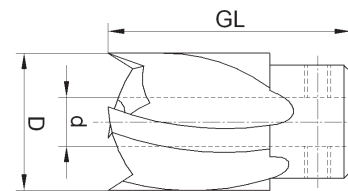
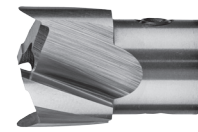

to be used in conjunction with twist drills and dowel drills • for shallow countersinks in soft- and hardwood

<i>d</i>	<i>D</i>	<i>GL</i>	<i>Z</i>	<i>HS</i>	<i>TC</i>	<i>RH</i>	<i>LH</i>	<i>Part number</i>
4	10	25	2	•		•		390.040.100.HS.R
5	12	25	2	•		•		390.050.120.HS.R
5	15	25	2	•		•		390.050.150.HS.R
6	15	25	2	•		•		390.060.150.HS.R
6	16	25	2	•		•		390.060.160.HS.R
6	20	30	2	•		•		390.060.200.HS.R
8	16	25	2	•		•		390.080.160.HS.R
8	20	30	2	•		•		390.080.200.HS.R
8	22	30	2	•		•		390.080.220.HS.R
8	25	30	2	•		•		390.080.250.HS.R
10	20	30	2	•		•		390.100.200.HS.R
10	25	30	2	•		•		390.100.250.HS.R
10	30	30	2	•		•		390.100.300.HS.R
12	25	30	2	•		•		390.120.250.HS.R
12	30	30	2	•		•		390.120.300.HS.R

410-2

DOWEL DRILL

- HS
- two cutting edges
- center point and spurs
- landed flute
- RH or LH rotation
- shank external thread M10

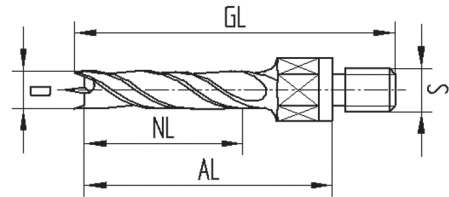

particularly for precise holes in soft- and hardwood on e. g. Ayen • Haffner • Holzma • Knoevenagel • Mayer • Pertici • Striffler • Torwegge

D	NL	AL	GL	S	Z	HS	TC	RH	LH	Part number
10	50	68	83	AG M10	2	•		•		410-2.100.500.HS.R
10	50	68	83	AG M10	2	•			•	410-2.100.500.HS.L
12	50	68	83	AG M10	2	•		•		410-2.120.500.HS.R
12	50	68	83	AG M10	2	•			•	410-2.120.500.HS.L
12	80	98	113	AG M10	2	•		•		410-2.120.800.HS.R
12	80	98	113	AG M10	2	•			•	410-2.120.800.HS.L
14	80	98	113	AG M10	2	•		•		410-2.140.800.HS.R
14	80	98	113	AG M10	2	•			•	410-2.140.800.HS.L
16	80	98	113	AG M10	2	•		•		410-2.160.800.HS.R
16	80	98	113	AG M10	2	•			•	410-2.160.800.HS.L

410-4

DOWEL DRILL

- HS
- two cutting edges
- center point and spurs
- landed flute
- RH or LH rotation
- shank external thread M10 and register 11x4 mm

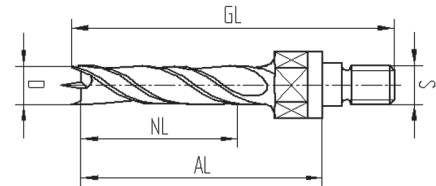
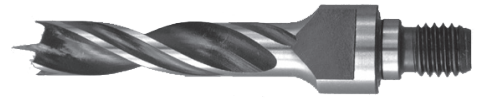

particularly for precise holes in soft- and hardwood on e. g. Biesse • Bussellato • Morbidelli • Torwegge • Weeke

D	NL	AL	GL	S	Z	HS	TC	RH	LH	Part number
10	45	62	78	AG M10+P	2	•		•		410-4.100.450.HS.R
10	45	62	78	AG M10+P	2	•			•	410-4.100.450.HS.L
12	45	62	78	AG M10+P	2	•		•		410-4.120.450.HS.R
12	45	62	78	AG M10+P	2	•			•	410-4.120.450.HS.L

471-2

HANDLE DRILL

- HS
 - two cutting edges
 - V-point
 - RH or LH rotation
 - shank external thread M10
- by request also available in coated design

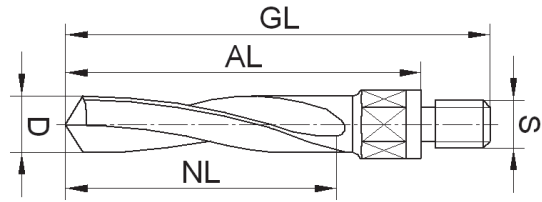

for drilling handles in UPVC profiles with or without steel insert and aluminium profiles on e.g. Ayen • elumatec • Haffner • Mayer • Pertici • Rotox • Striffler

D	NL	AL	GL	S	Z	HS	TC	RH	LH	Part number
8	50	72	87	AG M10	2	•			•	471-2.080.000.HS.L
10	30	57	72	AG M10	2	•			•	471-2.100.072.HS.L
10	50	72	87	AG M10	2	•		•		471-2.100.000.HS.R
10	50	72	87	AG M10	2	•			•	471-2.100.000.HS.L
10	80	98	113	AG M10	2	•		•		471-2.100.113.HS.R
10	80	98	113	AG M10	2	•			•	471-2.100.113.HS.L
12	35	61	76	AG M10	2	•		•		471-2.120.076.HS.R
12	50	72	87	AG M10	2	•		•		471-2.120.000.HS.R
12	50	72	87	AG M10	2	•			•	471-2.120.000.HS.L
12	80	98	113	AG M10	2	•		•		471-2.120.113.HS.R
12	80	98	113	AG M10	2	•			•	471-2.120.113.HS.L
13	50	72	87	AG M10	2	•		•		471-2.130.000.HS.R
13	50	72	87	AG M10	2	•			•	471-2.130.000.HS.L
14	50	72	87	AG M10	2	•		•		471-2.140.000.HS.R
14	50	72	87	AG M10	2	•			•	471-2.140.000.HS.L
14	80	98	113	AG M10	2	•		•		471-2.140.113.HS.R
14	80	98	113	AG M10	2	•			•	471-2.140.113.HS.L
15	35	61	76	AG M10	2	•		•		471-2.150.076.HS.R
15	50	72	87	AG M10	2	•		•		471-2.150.000.HS.R

472-2

HANDLE DRILL

- HS
 - two cutting edges
 - V-point and pilot 6x5 mm
 - RH or LH rotation
 - shank external thread M10
- by request also available in coated design

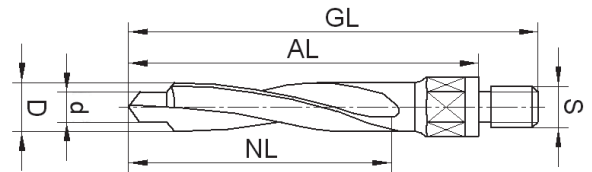

for drilling handles in UPVC profiles with or without steel insert and aluminium profiles on e.g. Ayen • elumatec • Haffner • Mayer • Pertici • Rotox • Striffler

D	d	NL	AL	GL	S	Z	HS	TC	RH	LH	Part number
10	6	47	69	84	AG M10	2	•		•		472-2.100.000.HS.R
10	6	50	72	87	AG M10	2	•			•	472-2.100.000.HS.L
10	6	80	98	113	AG M10	2	•		•		472-2.100.113.HS.R
10	6	80	98	113	AG M10	2	•			•	472-2.100.113.HS.L
12	6	47	69	84	AG M10	2	•		•		472-2.120.000.HS.R
12	6	50	72	87	AG M10	2	•			•	472-2.120.000.HS.L
12	6	80	98	113	AG M10	2	•		•		472-2.120.113.HS.R
12	6	80	98	113	AG M10	2	•			•	472-2.120.113.HS.L
14	6	47	69	84	AG M10	2	•		•		472-2.140.000.HS.R
14	6	50	72	87	AG M10	2	•			•	472-2.140.000.HS.L
14	6	80	98	113	AG M10	2	•		•		472-2.140.113.HS.R
14	6	80	98	113	AG M10	2	•			•	472-2.140.113.HS.L
15	6	47	69	84	AG M10	2	•		•		472-2.150.000.HS.R

474-2

QUADRO HANDLE DRILL

- HS
 - four cutting edges
 - V-point and pilot 6x5 mm
 - RH or LH rotation
 - shank external thread M10
- by request also available in coated design

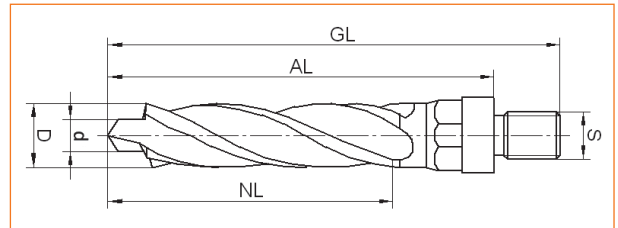
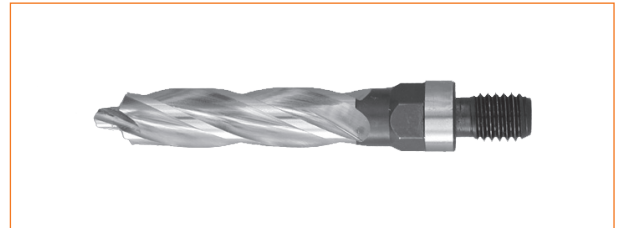

for drilling handles in UPVC profiles with or without steel insert and aluminium profiles on e.g. Ayen • elumatec • Haffner • Mayer • Pertici • Rotox • Striffler

D	d	NL	AL	GL	S	Z	HS	TC	RH	LH	Part number
10	6	50	72	87	AG M10	4	•		•		474-2.100.087.HS.R
10	6	50	72	87	AG M10	4	•			•	474-2.100.087.HS.L
10	6	80	98	113	AG M10	4	•		•		474-2.100.113.HS.R
10	6	80	98	113	AG M10	4	•			•	474-2.100.113.HS.L
12	6	50	72	87	AG M10	4	•		•		474-2.120.087.HS.R
12	6	50	72	87	AG M10	4	•			•	474-2.120.087.HS.L
12	6	80	98	113	AG M10	4	•		•		474-2.120.113.HS.R
12	6	80	98	113	AG M10	4	•			•	474-2.120.113.HS.L
14	6	50	72	87	AG M10	4	•		•		474-2.140.087.HS.R
14	6	50	72	87	AG M10	4	•			•	474-2.140.087.HS.L

607

LOCKSET CUTTER

- HS for plastic, soft- and hardwood
- TC for hardwood, wood composites and coated materials
- two straight cutting edges
- TC: with fitted plunge tip
- RH rotation
- parallel shank

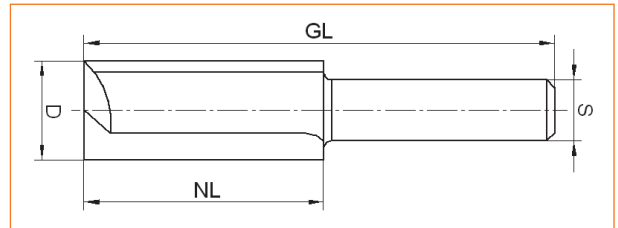

for use on portable and stationary routers with manual feed (MAN)

D	NL	GL	S	Z	HS	TC	RH	LH	Part number
8	30	100	8	2	•		•		6805.0830.0010.HS.R
10	25	70	10	2		•	•		6105.100.000.HW.R
10	35	75	10	2	•		•		6105.100.000.HS.R
10	40	75	8	2	•		•		6805.1040.0075.HS.R
10	40	97	10	2	•		•		6107.100.000.HS.R
12	25	70	10	2		•	•		6105.120.000.HW.R
12	40	75	8	2	•		•		6805.1240.0075.HS.R
12	40	75	10	2	•		•		6105.120.000.HS.R
12	40	97	10	2		•	•		6107.120.000.HW.R
12	48	97	10	2	•		•		6107.120.000.HS.R
14	25	70	10	2		•	•		6105.140.000.HW.R
14	40	75	10	2	•		•		6105.140.000.HS.R
14	40	97	10	2		•	•		6107.140.000.HW.R
14	48	97	10	2	•		•		6107.140.000.HS.R
16	25	70	10	2		•	•		6105.160.000.HW.R
16	40	75	10	2	•		•		6105.160.000.HS.R
16	45	97	10	2		•	•		6107.160.000.HW.R
16	48	97	10	2	•		•		6107.160.000.HS.R
18	25	70	10	2		•	•		6105.180.000.HW.R
18	35	87	10	2		•	•		6106.180.000.HW.R
18	40	75	10	2	•		•		6105.180.000.HS.R
18	42	87	10	2	•		•		6106.180.000.HS.R

640-7

GROOVING CUTTER

- HS
- either one or two straight cutting edges
- chip thickness limitation
- RH rotation
- shank internal thread M10 with spanner flat

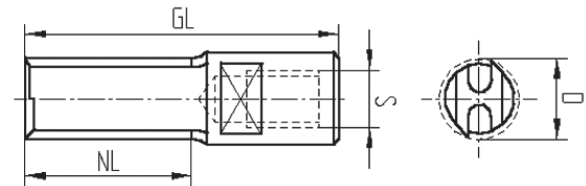

for working UPVC profiles on e. g. Rotox • Striffler in manual feed (MAN)

D	NL	GL	S	Z	HS	TC	RH	LH	Part number
3	8	52	IG M10	1	•		•		640-7.030.080.HS.R
4	10	35	IG M10	1	•		•		640-7.040.100.HS.R
4	12	52	IG M10	1	•		•		640-7.040.120.HS.R
5	10	35	IG M10	1	•		•		640-7.050.100.HS.R
5	23	52	IG M10	1	•		•		640-7.050.230.HS.R
6	22	52	IG M10	1	•		•		640-7.060.220.HS.R
8	26	47	IG M10	2	•		•		640-7.080.260.HS.R
10	20	43	IG M10	2	•		•		640-7.100.200.HS.R
10	30	50	IG M10	2	•		•		640-7.100.300.HS.R
11,5	16	50	IG M10	2	•		•		640-7.115.160.HS.R
12	14,5	43	IG M10	2	•		•		640-7.120.145.HS.R
12	23	43	IG M10	2	•		•		640-7.120.230.HS.R
12	38	58	IG M10	2	•		•		640-7.120.380.HS.R
14	21	43	IG M10	2	•		•		640-7.140.210.HS.R
14	30	51	IG M10	2	•		•		640-7.140.300.HS.R
16	23	43	IG M10	2	•		•		640-7.160.230.HS.R

708

WATER SLOT CUTTER

- HS
- one straight cutting edge
- without drillbit
- RH rotation
- without chip thickness limitation
- parallel shank

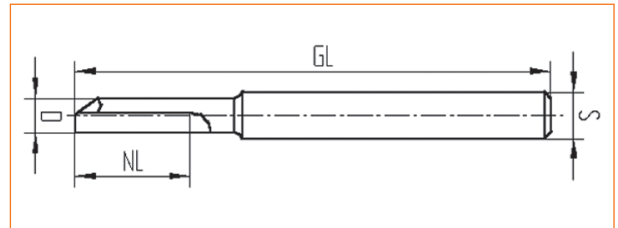
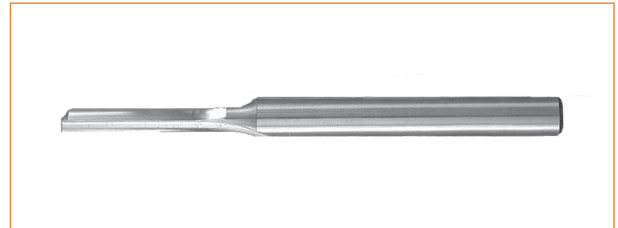

for cutting and milling of aluminium and UPVC profiles etc. on copying machines, water slot milling machines and machining centers e. g. AFS-Schirmer • elumatec • Haffner • Rapid • Rotox • Striffler • Wegoma

further dimensions on inquiry

D	NL	GL	S	Z	HS	TC	RH	LH	Part number
4	25	100	8	1	•		•		7808.0425.0010.HS.R
5	30	90	8	1	•		•		7808.0530.0090.HS.R
5	30	100	8	1	•		•		7808.0530.0010.HS.R
5	30	100	10	1	•		•		7108.0530.0010.HS.R

709

WATER SLOT CUTTER

- HS
- one straight cutting edge
- with drillbit
- RH rotation
- with chip thickness limitation
- parallel shank

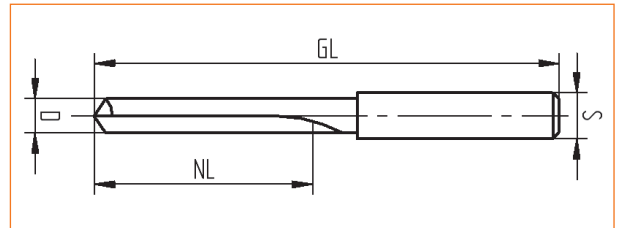
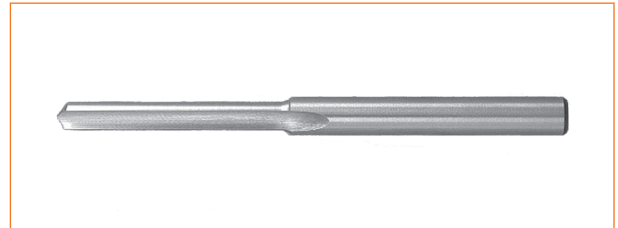

for cutting and milling of UPVC profiles on water slot milling machines e. g. elumatec • Haffner • Rotox • Striffler • Wegoma

further dimensions on inquiry

D	NL	GL	S	Z	HS	TC	RH	LH	Part number
4	25	100	8	1	•		•		7809.0425.0010.HS.R
5	30	70	8	1	•		•		7809.0530.0070.HS.R
5	30	100	8	1	•		•		7809.0530.0010.HS.R
5	35	80	8	1	•		•		7809.0535.0080.HS.R
5	35	100	8	1	•		•		7809.0535.0010.HS.R
5	45	100	8	1	•		•		7809.0545.0010.HS.R
5	45	120	8	1	•		•		7809.0545.0012.HS.R
5	55	100	8	1	•		•		7809.0555.0010.HS.R
5	55	120	8	1	•		•		7809.0555.0012.HS.R
6	30	100	8	1	•		•		7809.0630.0010.HS.R
6	45	100	8	1	•		•		7809.0645.0010.HS.R
6	48	90	8	1	•		•		7809.0648.0090.HS.R

701

SINGLE FLUTE CUTTER

- HS
- one helical cutting edge
- RH rotation
- parallel shank

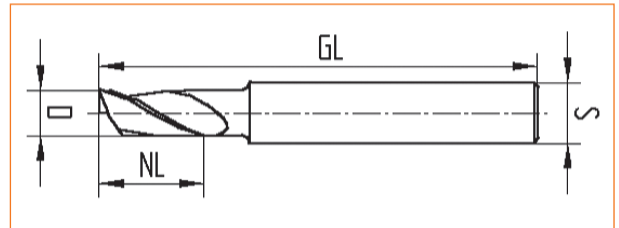
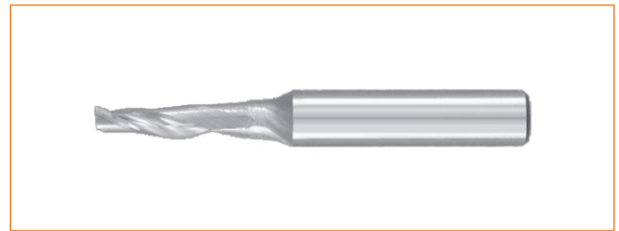

for cutting and milling of aluminium and UPVC profiles etc. on copying machines, water slot milling machines and machining centers e. g. AFS-Schirmer • elumatec • Haffner • Rapid • Rotox • Striffler • Wegoma

further dimensions on inquiry

D	NL	GL	S	Z	HS	TC	RH	LH	Part number
3	12	60	8	1	•		•		7801.0312.0060.HS.R
4	12	60	8	1	•		•		7801.0412.0060.HS.R
4	25	80	8	1	•		•		7801.0425.0080.HS.R
4	30	80	8	1	•		•		7801.0430.0080.HS.R
4	40	100	8	1	•		•		7801.0440.0010.HS.R
5	12	60	6	1	•		•		7601.0512.0060.HS.R
5	12	60	8	1	•		•		7801.0512.0060.HS.R
5	14	60	8	1	•		•		7801.0514.0060.HS.R
5	14	100	8	1	•		•		7801.0514.0010.HS.R
5	14	120	8	1	•		•		7801.0514.0012.HS.R
5	18	60	8	1	•		•		7801.0518.0060.HS.R
5	20	80	8	1	•		•		7801.0520.0080.HS.R
5	20	100	8	1	•		•		7801.0520.0010.HS.R
5	25	70	8	1	•		•		7801.0525.0070.HS.R
5	25	80	8	1	•		•		7801.0525.0080.HS.R
5	25	100	8	1	•		•		7801.0525.0010.HS.R
5	30	80	8	1	•		•		7801.0530.0080.HS.R
5	30	100	8	1	•		•		7801.0530.0010.HS.R
5	35	80	8	1	•		•		7801.0535.0080.HS.R
5	40	100	8	1	•		•		7801.0540.0010.HS.R
5	40	120	8	1	•		•		7801.0540.0012.HS.R
5	45	100	8	1	•		•		7801.0545.0010.HS.R
5	55	100	8	1	•		•		7801.0555.0010.HS.R
6	14	60	8	1	•		•		7801.0614.0060.HS.R
6	14	100	8	1	•		•		7801.0614.0010.HS.R
6	25	70	8	1	•		•		7801.0625.0070.HS.R
6	40	100	8	1	•		•		7801.0640.0010.HS.R
7	14	60	8	1	•		•		7801.0714.0060.HS.R
8	14	100	8	1	•		•		7801.0814.0010.HS.R
8	14	120	8	1	•		•		7801.0814.0012.HS.R
8	15	80	8	1	•		•		7801.0815.0080.HS.R
8	25	80	8	1	•		•		7801.0825.0080.HS.R
8	25	100	8	1	•		•		7801.0825.0010.HS.R
8	25	120	8	1	•		•		7801.0825.0012.HS.R
8	40	100	8	1	•		•		7801.0840.0010.HS.R
8	40	120	8	1	•		•		7801.0840.0012.HS.R
9	14	80	8	1	•		•		7801.0914.0080.HS.R
10	14	80	8	1	•		•		7801.1014.0080.HS.R
10	14	100	8	1	•		•		7801.1014.0010.HS.R
10	14	120	10	1	•		•		7101.1014.0012.HS.R
10	15	80	10	1	•		•		7101.1015.0080.HS.R
10	22	100	8	1	•		•		7801.1022.0010.HS.R
10	25	80	8	1	•		•		7801.1025.0080.HS.R
10	25	100	10	1	•		•		7101.1025.0010.HS.R
12	14	80	8	1	•		•		7801.1214.0080.HS.R
12	14	80	10	1	•		•		7101.1214.0080.HS.R
12	28	100	8	1	•		•		7801.1228.0010.HS.R
12	50	90	8	1	•		•		7801.1250.0090.HS.R

704

SINGLE FLUTE CUTTER

- HS
- one helical cutting edge
- RH rotation
- parallel shank
- special design for working steel

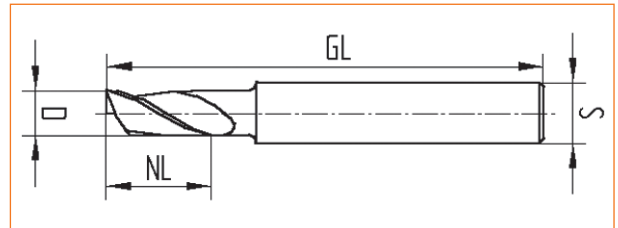
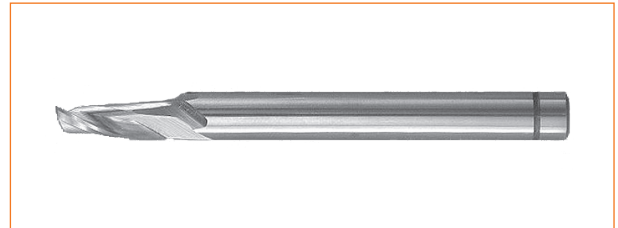

for working steel profiles on copying machines and machining centers e. g. AFS-Schirmer • elumatec • Haffner • Rapid • Rotox • Striffler • Wegoma

further dimensions on inquiry

D	NL	GL	S	Z	HS	TC	RH	LH	Part number
5	12	60	8	1	•		•		7804.0512.0060.HS.R
8	14	80	8	1	•		•		7804.0814.0080.HS.R

711

SINGLE FLUTE CUTTER

- STC
- one helical cutting edge
- RH rotation
- parallel shank

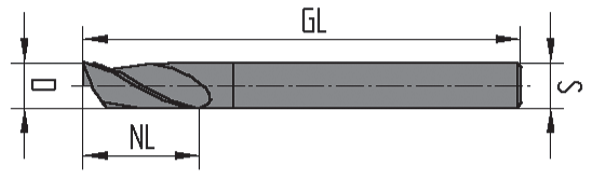

for cutting and milling of aluminium and UPVC profiles etc. on all kind of machining centers e. g. AFS-Schirmer • elumatec • Haffner • Rapid • Rotox • Schüco • Striffler • Wegoma

further dimensions on inquiry

D	NL	GL	S	Z	HS	TC	RH	LH	Part number
2	10	50	6	1		•	•		7611.0210.0050.VH.R
3	12	50	6	1		•	•		7611.0312.0050.VH.R
3	12	60	8	1		•	•		7811.0312.0060.VH.R
4	8	70	6	1		•	•		7611.0408.0070.VH.R
4	12	70	4	1		•	•		7411.0412.0070.VH.R
4	12	70	6	1		•	•		7611.0412.0070.VH.R
4	14	60	6	1		•	•		7611.0414.0060.VH.R
4	15	50	4	1		•	•		7411.0415.0050.VH.R
4	20	60	8	1		•	•		7811.0420.0060.VH.R
4	30	80	4	1		•	•		7411.0430.0080.VH.R
5	12	70	5	1		•	•		7511.0512.0070.VH.R
5	12	100	8	1		•	•		7811.0512.0010.VH.R
5	15	70	8	1		•	•		7811.0515.0070.VH.R
5	18	70	5	1		•	•		7511.0518.0070.VH.R
5	18	80	6	1		•	•		7611.0518.0080.VH.R
5	20	60	5	1		•	•		7511.0520.0060.VH.R
5	20	60	6	1		•	•		7611.0520.0060.VH.R
5	20	60	8	1		•	•		7811.0520.0060.VH.R
5	20	80	8	1		•	•		7811.0520.0080.VH.R
5	25	80	8	1		•	•		7811.0525.0080.VH.R
5	30	70	5	1		•	•		7511.0530.0070.VH.R
5	30	80	5	1		•	•		7511.0530.0080.VH.R
5	30	80	8	1		•	•		7811.0530.0080.VH.R
5	30	90	5	1		•	•		7511.0530.0090.VH.R
5	30	90	8	1		•	•		7811.0530.0090.VH.R
5	30	113	8	1		•	•		7811.0530.0011.VH.R
5	35	90	8	1		•	•		7811.0535.0090.VH.R
5	40	80	5	1		•	•		7511.0540.0080.VH.R
5	40	80	6	1		•	•		7611.0540.0080.VH.R
5	40	80	8	1		•	•		7811.0540.0080.VH.R
5	40	100	8	1		•	•		7811.0540.0010.VH.R
5	45	80	5	1		•	•		7511.0545.0080.VH.R
6	12	70	6	1		•	•		7611.0612.0070.VH.R
6	12	100	6	1		•	•		7611.0612.0010.VH.R
6	16	60	6	1		•	•		7611.0616.0060.VH.R
6	20	70	6	1		•	•		7611.0620.0070.VH.R
6	30	80	6	1		•	•		7611.0630.0080.VH.R
6	40	80	6	1		•	•		7611.0640.0080.VH.R
8	16	100	8	1		•	•		7811.0816.0010.VH.R
8	18	60	8	1		•	•		7811.0818.0060.VH.R
8	25	75	8	1		•	•		7811.0825.0075.VH.R
8	25	80	8	1		•	•		7811.0825.0080.VH.R
8	30	90	8	1		•	•		7811.0830.0090.VH.R
8	35	90	8	1		•	•		7811.0835.0090.VH.R
8	40	80	8	1		•	•		7811.0840.0080.VH.R
10	22	70	10	1		•	•		7111.1022.0070.VH.R
10	32	90	10	1		•	•		7111.1032.0090.VH.R
10	52	100	10	1		•	•		7111.1052.0010.VH.R
12	35	100	12	1		•	•		7211.1235.0010.VH.R
12	45	83	10	1		•	•		7111.1245.0083.VH.R
12	50	100	12	1		•	•		7211.1250.0010.VH.R

717

SINGLE FLUTE CUTTER

- STC
- one helical cutting edge
- LH spiral / RH cut
- parallel shank

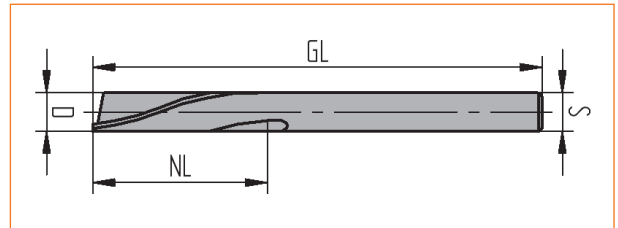
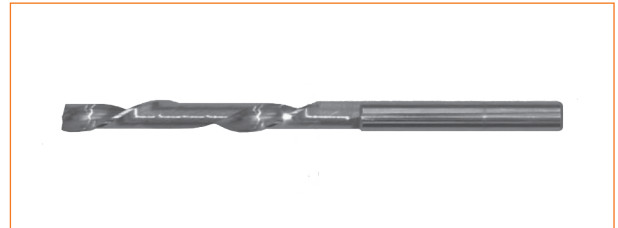

for cutting and milling of aluminium and UPVC profiles etc. on copying machines e. g. elumatec • Haffner • Rapid • Rotox • Striffler • Wegoma

further dimensions on inquiry

D	NL	GL	S	Z	HS	TC	RH	LH	Part number
5	20	60	5	1		•	•		7517.0520.0060.VH.LR
5	25	60	5	1		•	•		7517.0525.0060.VH.LR
5	40	80	5	1		•	•		7517.0540.0080.VH.LR
6	20	60	6	1		•	•		7617.0620.0060.VH.LR
8	40	90	8	1		•	•		7817.0840.0090.VH.LR
10	30	75	10	1		•	•		7117.1030.0075.VH.LR
12	30	75	12	1		•	•		7217.1230.0075.VH.LR

703

SINGLE FLUTE CUTTER

- HS
- one helical cutting edge
- RH rotation
- narrow neck
- parallel shank

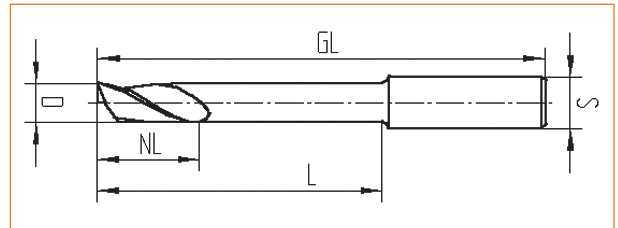

for cutting and milling of aluminium and UPVC profiles etc. on copying machines, water slot milling machines and machining centers e. g. AFS-Schirmer • elumatec • Haffner • Rapid • Rotox • Striffler • Wegoma

further dimensions on inquiry

D	NL	L	GL	S	Z	HS	TC	RH	LH	Part number
4	16	45	90	8	1	•		•		7803.0416.4590.HS.R
4	18	35	80	8	1	•		•		7803.0418.3580.HS.R
5	14	33	80	8	1	•		•		7803.0514.3380.HS.R
5	14	33	120	8	1	•		•		7803.0514.3312.HS.R
5	14	35	120	8	1	•		•		7803.0514.3512.HS.R
5	14	75	120	8	1	•		•		7803.0514.7512.HS.R
5	16	45	90	8	1	•		•		7803.0516.4590.HS.R
5	18	35	80	8	1	•		•		7803.0518.3580.HS.R
5	18	35	100	8	1	•		•		7803.0518.3510.HS.R
5	25	55	100	8	1	•		•		7803.0525.5510.HS.R
5	40	60	100	8	1	•		•		7803.0540.6010.HS.R
6	14	35	80	8	1	•		•		7803.0614.3580.HS.R
6	14	35	100	8	1	•		•		7803.0614.3510.HS.R
6	16	45	90	8	1	•		•		7803.0616.4590.HS.R
6	18	35	100	8	1	•		•		7803.0618.3510.HS.R
8	14	54	80	8	1	•		•		7803.0814.5480.HS.R
8	14	68	100	8	1	•		•		7803.0814.6810.HS.R
8	14	90	120	8	1	•		•		7803.0814.9012.HS.R
8	30	70	100	8	1	•		•		7803.0830.7010.HS.R
8	30	70	120	8	1	•		•		7803.0830.7012.HS.R
10	14	65	85	10	1	•		•		7103.1014.6585.HS.R
10	14	75	96	10	1	•		•		7103.1014.7596.HS.R
10	14	95	120	10	1	•		•		7103.1014.9512.HS.R
10	22	70	120	10	1	•		•		7103.1022.7012.HS.R
10	25	45	90	10	1	•		•		7103.1025.4590.HS.R
10	30	70	100	10	1	•		•		7103.1030.7010.HS.R
10	30	70	120	10	1	•		•		7103.1030.7012.HS.R

713.719

SINGLE FLUTE CUTTER

- STC
- one helical cutting edge
- RH rotation
- narrow neck
- parallel shank
- 719: serrated grinding • wide flute

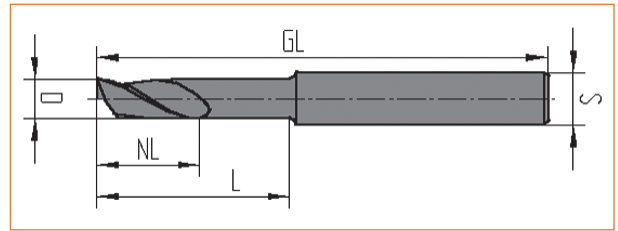
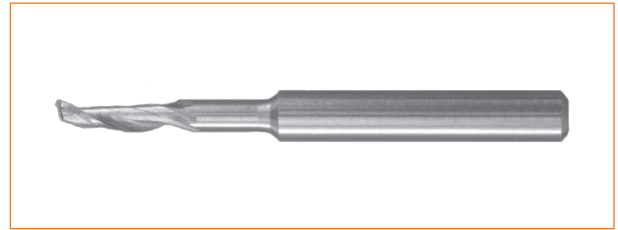

for cutting and milling of aluminium and UPVC profiles etc. on all kind of machining centers e. g. AFS-Schirmer • elumatec • Haffner • Rapid • Rotox • Schüco • Striffler • Wegoma

further dimensions on inquiry

D	NL	L	GL	S	Z	HS	TC	RH	LH	Part number
4	18	35	80	8	1		•	•		7813.04018.3580.VH.R
5	8	40	77	6	1		•	•		7613.0508.4077.VH.R
5	16	35	80	8	1		•	•		7813.0516.3580.VH.R
5	20	45	90	8	1		•	•		7813.0520.4590.VH.R
5	30	50	100	8	1		•	•		7813.0530.5010.VH.R
5	30	60	100	8	1		•	•		7813.0530.6010.VH.R
5	30	62	110	8	1		•	•		7813.0530.6211.VH.R
5	35	55	90	8	1		•	•		7813.0535.5590.VH.R
5	40	50	100	8	1		•	•		7813.0540.5010.VH.R
6	10	40	77	6	1		•	•		7613.0610.4077.VH.R
6	20	30	90	8	1		•	•		7813.0620.3090.VH.R
6	20	35	80	8	1		•	•		7813.0620.3580.VH.R
8	10	40	80	8	1		•	•		7813.0810.4080.VH.R
8	14	70	100	8	1		•	•		7813.0814.7010.VH.R
8	25	60	100	8	1		•	•		7813.0825.6010.VH.R
8	35	50	90	8	1		•	•		7813.0835.5090.VH.R
8	35	50	90	8	1		•	•		7819.0835.5090.VH.RW
8	35	80	120	8	1		•	•		7813.0835.8012.VH.R
10	15	65	110	10	1		•	•		7113.1015.6511.VH.R
10	15	82	120	10	1		•	•		7113.1015.8212.VH.R
10	17	70	100	10	1		•	•		7113.1017.7010.VH.R
10	20	70	100	10	1		•	•		7113.1020.7010.VH.R
12	20	70	100	12	1		•	•		7219.1220.7010.VH.RW

710

WATER SLOT CUTTER

- HS
- two helical cutting edges
- RH rotation
- parallel shank

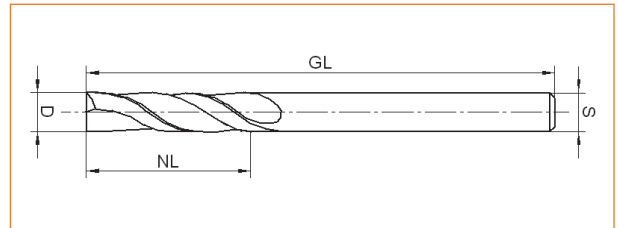
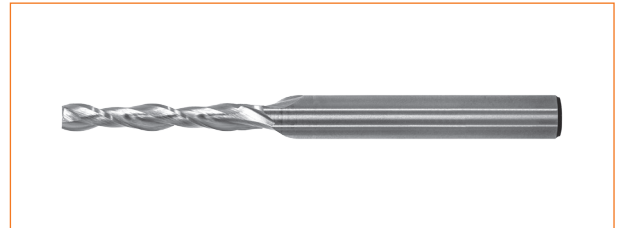

for cutting and milling of aluminium profiles on water slot milling machines e. g. elumatec • Haffner • Rotox
• Striffler • Wegoma

further dimensions on inquiry

D	NL	GL	S	Z	HS	TC	RH	LH	Part number
5	30	90	8	2	•		•		7810.0530.0090.HS.R
5	40	100	8	2	•		•		7810.0540.0010.HS.R

706

LOCKSET CUTTER

- HS
- two helical cutting edges
- RH rotation
- parallel shank

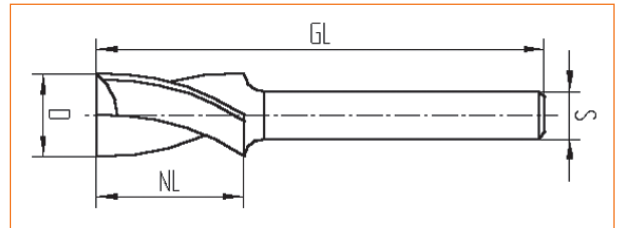

for working UPVC profiles on copying machines e. g. Rapid • Striffler • Wegoma

further dimensions on inquiry

D	NL	GL	S	Z	HS	TC	RH	LH	Part number
8	30	100	8	2	•		•		7806.0830.0010.HS.R
8	40	100	8	2	•		•		7806.0840.0010.HS.R
10	25	75	8	2	•		•		7806.1025.0075.HS.R
10	25	120	10	2	•		•		7106.1025.0012.HS.R
10	45	95	10	2	•		•		7106.1045.0095.HS.R
10	50	100	10	2	•		•		7106.1050.0010.HS.R
12	14	100	8	2	•		•		7806.1214.0010.HS.R
12	14	120	8	2	•		•		7806.1214.0012.HS.R
12	25	75	8	2	•		•		7806.1225.0075.HS.R
12	25	85	8	2	•		•		7806.1225.0085.HS.R
12	35	90	12	2	•		•		7206.1235.0090.HS.R
12	50	90	8	2	•		•		7806.1250.0090.HS.R
12	53	110	12	2	•		•		7206.1253.0011.HS.R
14	25	75	8	2	•		•		7806.1425.0075.HS.R
14	53	110	12	2	•		•		7206.1453.0011.HS.R
16	25	75	8	2	•		•		7806.1625.0075.HS.R
20	75	141	20	2	•		•		7V06.2075.0014.HS.R

707

WATER SLOT CUTTER

- HS
- two helical cutting edges
- LH spiral / RH cut
- parallel shank

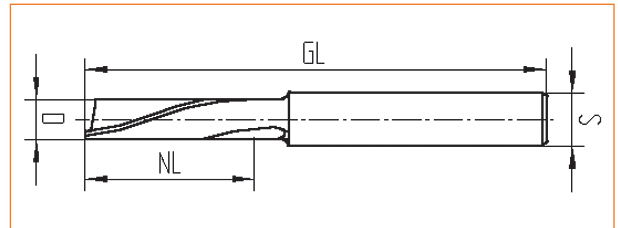
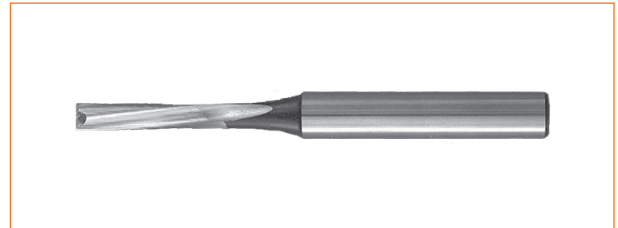

for cutting and milling of aluminium and UPVC profiles etc. on copying machines e. g. elumatec • Haffner • Rapid • Rotox • Striffler • Wegoma

further dimensions on inquiry

D	NL	GL	S	Z	HS	TC	RH	LH	Part number
5	15	70	8	2	•		•		7807.0515.0070.HS.LR
5	25	80	8	2	•		•		7807.0525.0080.HS.LR
5	35	80	8	2	•		•		7807.0535.0080.HS.LR
5	40	100	8	2	•		•		7807.0540.0010.HS.LR

712

MILLING CUTTER

- STC
- two helical cutting edges
- RH or LH rotation
- parallel shank

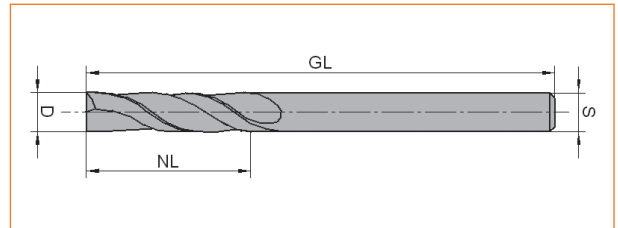
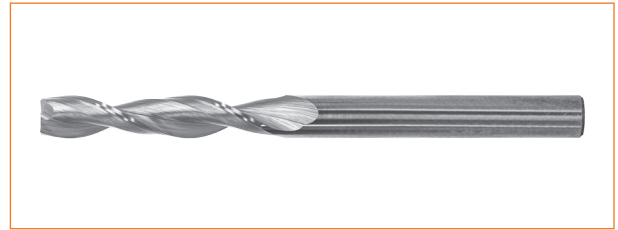

designed for all kind of machining centers

further dimensions on inquiry

D	NL	GL	S	Z	HS	TC	RH	LH	Part number
2,5	8	58	6	2		•	•		7612.Y208.0058.VH.R
3	10	40	3	2		•	•		7312.0310.0040.VH.R
4	10	60	6,35	2		•	•		7712.0410.0060.VH.R
4	10	80	6,35	2		•	•		7712.0410.0080.VH.R
4	25	50	4	2		•	•		7412.0425.0050.VH.R
5	30	70	5	2		•	•		7512.0530.0070.VH.R
6	40	100	6	2		•	•		7612.0640.0010.VH.R
8	18	60	8	2		•	•		7812.0818.0060.VH.R
8	35	80	8	2		•	•		7812.0835.0080.VH.R
8	40	100	8	2		•	•		7812.0840.0010.VH.R
8,5	35	100	12	2		•	•		7212.08535.0010.VH.R
9	35	70	12	2		•	•	•	7212.0935.0070.VH.L
10	40	100	10	2		•	•		7112.1040.0010.VH.R
12	35	90	8	2		•	•		7812.1235.0090.VH.R
12	35	90	12	2		•	•		7212.1235.0090.VH.R
12	40	120	12	2		•	•		7212.1240.0012.VH.R
12	45	100	12	2		•	•		7212.1245.0010.VH.R

723

MILLING CUTTER

- HS
- two helical cutting edges
- RH or LH rotation
- narrow neck
- parallel shank

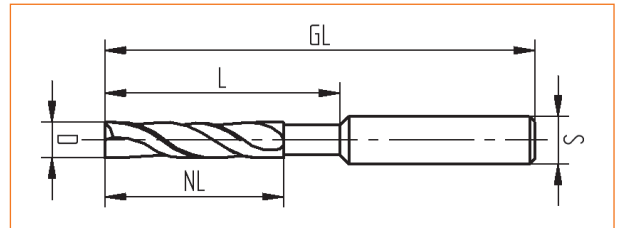

for cutting and milling of aluminium and UPVC profiles etc. on copying machines e. g. elumatec KF 178

D	NL	L	GL	S	Z	HS	TC	RH	LH	Part number
7	14	60	80	8	2	•		•		7823.0714.6080.HS.R
10	22	40	100	10	2	•			•	7123.1022.4010.HS.L
10	22	60	100	10	2	•		•		7123.1022.6010.HS.R
10	22	70	120	10	2	•		•		7123.1022.7012.HS.R

733

MILLING CUTTER

- STC
- two helical cutting edges
- RH rotation
- narrow neck
- parallel shank

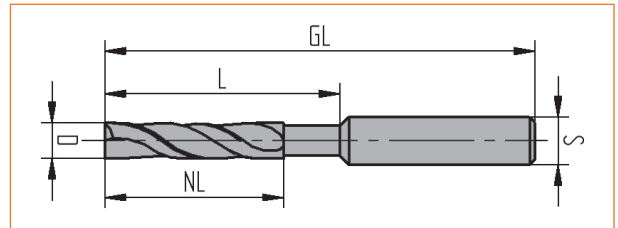

designed for all kind of machining centers

D	NL	L	GL	S	Z	HS	TC	RH	LH	Part number
6	20	60	120	8	2		•	•		7833.0620.6012.VH.R
8	35	42	100	10	2		•	•		7133.0835.4210.VH.R
10	12	60	90	10	2		•	•		7133.1012.6090.VH.R
12	12	60	100	12	2		•	•		7233.1212.6010.VH.R

721

MILLING CUTTER

- HS or STC
- inside rabbet / lining groove cutter
- two or three helical cutting edges
- RH rotation
- parallel shank

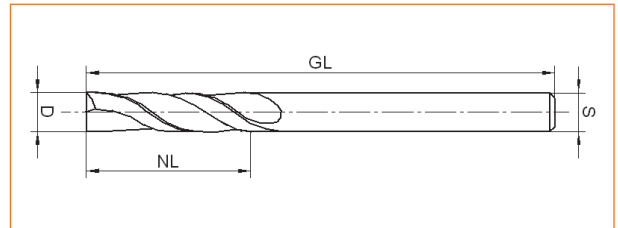

designed for corner cleaning machines e. g. elumatec • Urban • Wegoma

further dimensions on inquiry

D	NL	GL	S	Z	HS	TC	RH	LH	Part number
5	24	68	6	2	•		•		7621.0524.0268.HS.R
6	20	120	6	2		•	•		7621.0620.0212.VH.R
6	25	100	8	2		•	•		7821.0625.0210.VH.R
6	40	120	6	3		•	•		7621.0640.0312.VH.R
7	20	100	8	2	•		•		7821.0720.0210.HS.R
7	20	100	8	3	•		•		7821.0720.0310.HS.R
7	20	100	8	3		•	•		7821.0720.0310.VH.R
7	20	120	8	2	•		•		7821.0720.0212.HS.R
7	20	120	8	3	•		•		7821.0720.0312.HS.R
7	25	100	8	2		•	•		7821.0725.0210.VH.R
8	20	100	8	3	•		•		7821.0820.0310.HS.R
8	20	120	8	2	•		•		7821.0820.0212.HS.R
8	20	120	8	3	•		•		7821.0820.0312.HS.R

739

ROUGHING CUTTER

- HS
- four helical cutting edges
- RH rotation
- chip breaking roughing teeth
- parallel shank

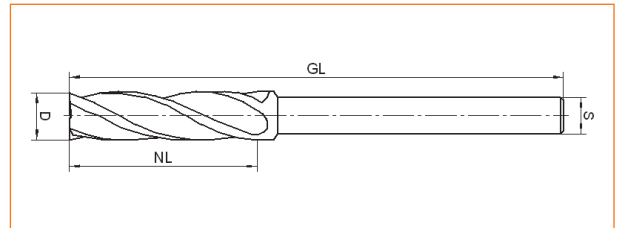

for use on machining centers e. g. elumatec • Stürtz • Rotox

further dimensions on inquiry

<i>D</i>	<i>NL</i>	<i>GL</i>	<i>S</i>	<i>Z</i>	<i>HS</i>	<i>TC</i>	<i>RH</i>	<i>LH</i>	<i>Part number</i>
12	26	83	8	4	•		•		7839.1226.0483.HS.R
12	53	110	12	4	•		•		7239.1253.0411.HS.R
13	53	110	10	4	•		•		7139.1353.0411.HS.R
13	53	110	12	4	•		•		7239.1353.0411.HS.R
14	53	110	10	4	•		•		7139.1453.0411.HS.R

720

WATER SLOT CUTTER

- STC
- one helical cutting edge
- drillbit 90°
- RH rotation
- parallel shank

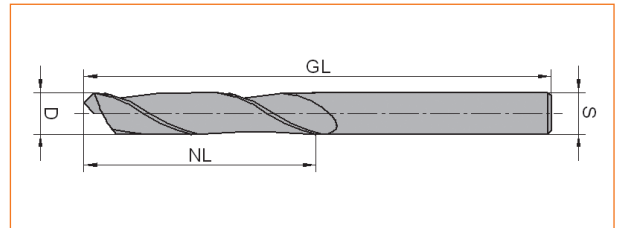

special design for CNC-machining centers e. g. AFS-Schirmer • elumatec • Haffner • Rapid

further dimensions on inquiry

<i>D</i>	<i>NL</i>	<i>GL</i>	<i>S</i>	<i>Z</i>	<i>HS</i>	<i>TC</i>	<i>RH</i>	<i>LH</i>	<i>Part number</i>
5	20	60	8	1		•	•		7820.0520.9060.VH.R
5	30	80	8	1		•	•		7820.0530.9080.VH.R
5	30	90	8	1		•	•		7820.0530.9090.VH.R
5	40	80	5	1		•	•		7520.0540.9080.VH.R
5	40	80	8	1		•	•		7820.0540.9080.VH.R
6	40	80	6	1		•	•		7620.0640.9080.VH.R
6	45	90	6	1		•	•		7620.0645.9090.VH.R

743

WATER SLOT CUTTER

- STC
- one helical cutting edge
- drillbit 90°
- RH rotation
- serrated grinding
- narrow neck
- parallel shank

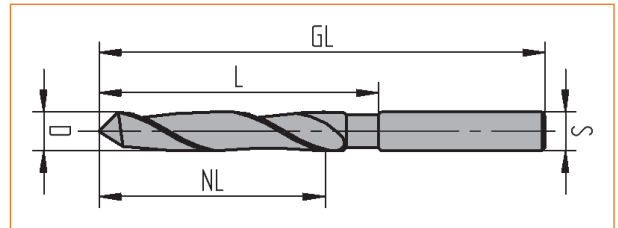

special design for CNC-machining centers e. g. AFS-Schirmer • elumatec • Haffner • Rapid

D	NL	L	GL	S	Z	HS	TC	RH	LH	Part number
5	35	55	90	8	1		•	•		7843.0535.5590.VH.RW
5	35	55	100	8	1		•	•		7843.0535.5510.VH.RW

726

WATER SLOT CUTTER

- STC
- one helical cutting edge
- drillbit
- RH or LH rotation
- serrated grinding
- narrow neck
- parallel steel shank

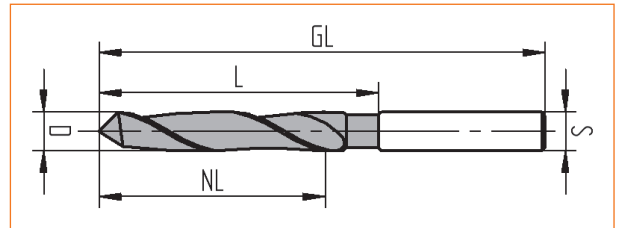

designed for CNC-machining centers e. g. AFS-Federhenn • AFS-Schirmer • Rotox

D	NL	L	GL	S	Z	HS	TC	RH	LH	Part number
5	30	50	100	8	1		•	•		7826.0530.5010.VS.RW
5	30	50	100	8	1		•		•	7826.0530.5010.VS.LW
5	34	45	90	8	1		•	•		7826.0534.4590.VS.RW

747

WATER SLOT CUTTER

- STC
- one helical cutting edge
- drillbit
- LH spiral / RH cut
- narrow neck
- parallel steel shank

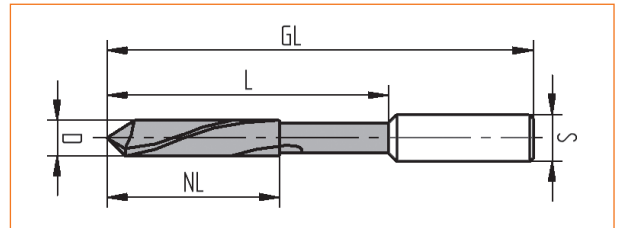

designed for CNC-machining centers e. g. AFS-Federhenn • AFS-Schirmer • Rotox

D	NL	L	GL	S	Z	HS	TC	RH	LH	Part number
5	30	50	98	8	1		•	•		7847.0530.5098.VS.LR
5	30	50	100	8	1		•	•		7847.0530.5010.VS.LRW

705

WATER SLOT CUTTER

- HS
- two helical cutting edges
- drillbit 90°
- RH rotation
- parallel shank

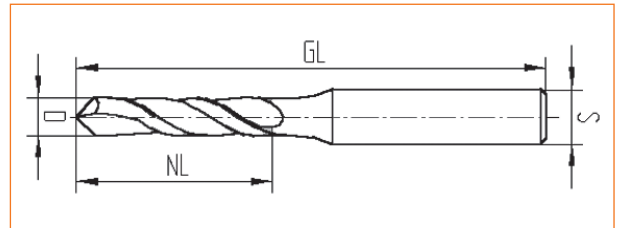
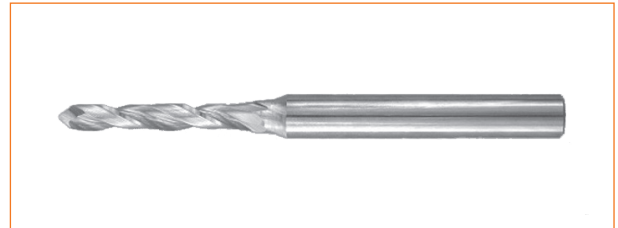

for cutting and milling of UPVC profiles on water slot milling machines e. g. elumatec • Haffner • Rotox • Striffler • Wegoma

further dimensions on inquiry

D	NL	GL	S	Z	HS	TC	RH	LH	Part number
5	20	100	8	2	•		•		7805.0520.9010.HS.R
5	30	90	8	2	•		•		7805.0530.9090.HS.R
5	40	90	8	2	•		•		7805.0540.9090.HS.R
5	40	100	8	2	•		•		7805.0540.9010.HS.R

715

WATER SLOT CUTTER

- STC
- two helical cutting edges
- drillbit 90°
- RH rotation
- parallel shank

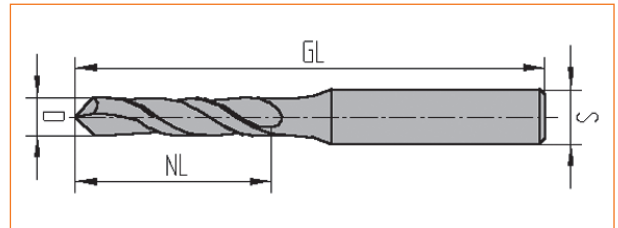

for cutting and milling of UPVC profiles on machining centers e. g. AFS-Schirmer • elumatec • Haffner • Rapid
further dimensions on inquiry

D	NL	GL	S	Z	HS	TC	RH	LH	Part number
5	20	60	8	2		•	•		7815.0520.9060.VH.R
5	30	90	8	2		•	•		7815.0530.9090.VH.R
5	40	80	5	2		•	•		7515.0540.9080.VH.R
5	40	80	8	2		•	•		7815.0540.9080.VH.R
5	40	100	5	2		•	•		7515.0540.9010.VH.R
5	40	100	8	2		•	•		7815.0540.9010.VH.R
5	45	100	8	2		•	•		7815.0545.9010.VH.R
6	30	90	8	2		•	•		7815.0630.9090.VH.R
6	45	90	8	2		•	•		7815.0645.9090.VH.R
8	65	100	8	2		•	•		7815.0865.9010.VH.R



...simply top!

NAPOLÉON
WERKZEUGE

ALPHABETICAL INDEX

COPYING CUTTER..... 15-23 • 25 • 31-36
COUNTERSINK..... 7
CUTTER..... 13-36

DOWEL DRILL..... 3-6 • 8-12
DRILL..... 3-6 • 8-12

GROOVING CUTTER..... 13-29 • 31-36

HANDLE DRILL..... 8-12

INSIDE RABBET CUTTER..... 29
INSIDE RABBET GROOVE CUTTER..... 29
INSIDE RABBET LINING GROOVE CUTTER..... 29

LINING GROOVE CUTTER..... 29
LOCKSET CUTTER..... 13 • 24
LOOSE COUNTERSINK..... 7

MILLING CUTTER..... 24 • 26-30

QUADRO HANDLE DRILL..... 12

ROUGHING CUTTER..... 30
ROUTER..... 13-36

SINGLE FLUTE CUTTER..... 15-22 • 31-34
SINKER..... 7
STEPPED DRILL..... 11-12
STOCKADE DRILL..... 6

TWIST DRILL..... 3-6 • 8-12

WATER SLOT CUTTER..... 15-23 • 25 • 31-36



...simply top!



NUMERICAL INDEX

2 05	3	7101	17	7801	17
210	4	7103	21	7803	21
213	5	7106	24	7804	18
215	6	7108	15	7805	35
		7111	19	7806	24
		7112	26	7807	25
		7113	22	7808	15
3 90	7	7117	20	7809	16
		7123	27	7810	23
		7133	28	7811	19
		7139	30	7812	26
				7813	22
4 10-2	8	7206	24	7815	36
410-4	9	7211	19	7817	20
471-2	10	7212	26	7819	22
472-2	11	7217	20	7820	31
474-2	12	7219	22	7821	29
		7233	28	7823	27
		7239	30	7826	33
				7833	28
6 07	13	7312	26	7839	30
640-7	14	7411	19	7843	32
6105	13	7412	26	7847	34
6106	13			7V06	24
6107	13	7511	19		
6805	13	7512	26		
		7515	36		
7 01	17	7517	20		
703	21	7520	31		
704	18				
705	35	7601	17		
706	24	7611	19		
707	25	7612	26		
708	15	7613	22		
709	16	7617	20		
710	23	7620	31		
711	19	7621	29		
712	26				
713	22	7712	26		
715	36				
717	20				
719	22				
720	31				
721	29				
723	27				
726	33				
733	28				
739	30				
743	32				
747	34				

General Terms and Conditions



1	General Terms and Conditions of Contract
1.1	The acceptance and performance of orders are subject to our Business Terms and Conditions set forth below. Deviations must be agreed upon in writing. Unless the wording of the offer indicates differently, our offers are non-binding and subject to change.
1.2	Our Business Terms and Conditions are deemed acknowledged when an order is issued or a delivery accepted. Similarly, they are deemed acknowledged if order confirmations are not objected to.
1.3	Deviating business terms and conditions of the customer are not binding on us, including where we do not expressly object to them.
1.4	The customer grants us the right to rescind the contract if order performance is impossible as a result of force majeure, strikes, lock-outs, or similar unforeseen events.
1.5	The customer is liable for the accuracy of the documents provided to us, such as drawings, samples, etc.
1.6	Absent our express consent, our documents, such as drawings, samples, etc., may not be made accessible to others. Our express approval is required in order to reprint the content of the catalogue, including excerpts thereof.
1.7	For items offered or promised for delivery from the warehouse, we reserve the ability to make prior sales to others.
1.8	In the event that individual sections of the Business Terms and Conditions are ineffective, or if same are superseded by other agreements, the remaining contractual content remains unaffected thereby and is binding.
1.9	When new price documentation is issued, previous price lists, offers, etc. are no longer valid.
2	Prices
2.1	Unless other agreements were made for a certain delivery, the applicable deliver prices are those on the date of delivery.
2.2	Unless differently worded agreements were made, prices are in € (EUR), net of value-added tax, ex works and excluding packaging. Value-added tax is based on the tax law on the date of delivery. For small orders, a variable surcharge of up to € 30,00 net order value is charged per order.
2.3	Prices are applicable only for the specified normal performance. Deviations in terms of nature, construction, or sizes constitute custom-made products and are charged according to our determinations, including without express designation. Where follow-on orders are placed for custom-made products, no claim can be asserted for previous prices.
2.4	Modifications, special requests and cancellations that are made after contract conclusion may be separately charged in the amount of the incurred costs.
2.5	The customer bears any added costs for express shipment, insurance, etc. where it issued such special instructions.
3	Delivery
3.1	Details concerning delivery times are non-binding. Delivery dates are set by us with the requisite care. They are set by taking into consideration the foreseeable production processes on such date.
3.2	Delivery times begin to run on the date of order confirmation.
3.3	The delivery deadline is extended if unforeseen impediments occur (operational interruptions, delay in delivery by our input suppliers, etc.) that were unable to be avoided despite efforts.
3.4	If the scheduled delivery time, including where extended pursuant to 3.3, is exceeded by more than two months, the customer has the right to rescind the contract after setting a grace period of four weeks.
3.5	Unless expressly agreed otherwise, the customer declares that it is in agreement with partial deliveries and, in the case of custom-made products, with reasonable under- and over-deliveries. Each partial delivery is considered a separate transaction within the meaning of the Business Terms and Conditions.
3.6	Order cancellations and accruals require our written consent. Incurred costs must be reimbursed by the ordering party. Tools may be returned only with our consent. Custom-made products are not taken back. In the case of self-caused returns for credit, a processing fee of € 10,00 per item is charged.
3.7	Shipments are generally dispatched at the customer's risk and expense.
4	Payment Terms
4.1	Our invoices are due and payable within 30 days, net. Repairs are immediately due and payable without deduction.
4.2	Cheques and bills of exchange are not accepted in lieu of payment.
4.3	In the case of default in payment, we are entitled to charge incurred costs and customary bank interest.
4.4	If the customer is in default in payment, we are entitled to withhold outstanding deliveries or to make same against prepayment or cash on delivery. Promised delivery dates may be extended accordingly.
4.5	The buyer may not withhold payments or offset contested counter-claims.
5	Warranty • Liability • Objections to Defects
5.1	We guarantee the delivery of flawless tools, proper performance and steel quality according to the catalogue description. Because of technical progress, we must make reservations for deviations in images, drawings, etc.
5.2	Technical changes and deviations from the catalogue description, image, etc. give the right to complaints only if they constitute an obstacle to the contract purpose. The same also applies to flaws that do not interfere with the intended use of a good.
5.3	Objections must be made within one week of receipt of the goods. The reason for the objection must be described in detail. In the case of flaws that are not immediately discernible, written notice must be given promptly after they become discernible.
5.4	We are not liable for latent defects (e. g. material flaws, etc.) or for defects caused by wear and tear, excessive use, improper handling, unauthorised changes, or improper maintenance.
5.5	For justified objections to defects, we reserve the right to cure or make replacement delivery. Claims of any nature for compensation of damages, including consequential damages, are precluded, other in cases of gross negligence on our part.
6	Retention of Title
6.1	The customer's right to use the goods or to sell them in the normal course of business lapses with the suspension of payments. If the customer is in default in payment, we may revoke this right with respect to the unpaid goods. The purchaser is not permitted to pledge the delivered goods or to assign them for the purposes of security. We must be immediately notified in the event of liens or seizures by a third party. In the event that a good is resold, the purchaser thereupon assigns its claim to us against the acquirer in the amount of the invoice (extended retention of title).
7	Place of Performance • Place of Jurisdiction
7.1	D-73432 Aalen-Niesitz is the place of performance for delivery and payment. The place of jurisdiction is the one with statutory competence over us. Under given circumstances, we reserve the ability to bring suit at the customer's place of jurisdiction. All legal relationships are subject exclusively to German law.



Reese + Fischer GmbH + Co. KG

Nietheimer Straße 30

D-73432 Aalen-Niesitz

Phone (+49) 07367-96971-0

info@napoleon-werkzeuge.de

www.napoleon-werkzeuge.de

1 e/2024

