

NAPOLÉON[®]
WERKZEUGE

Reese + Fischer GmbH + Co. KG

www.napoleon-werkzeuge.de

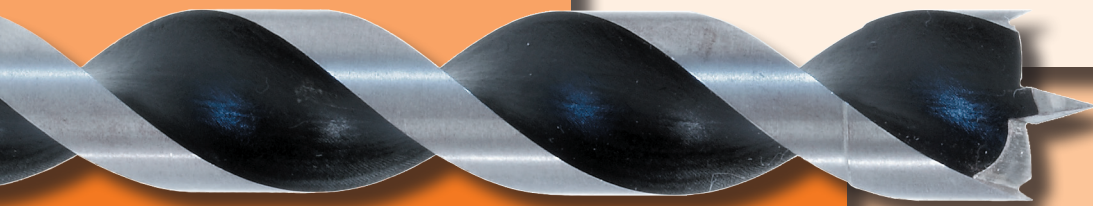
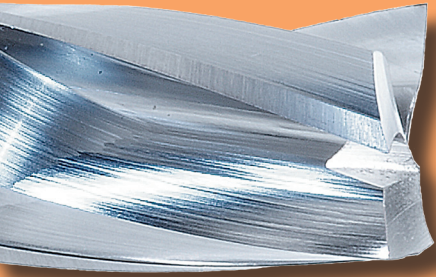

Assortment L



Shank-mounted tools
for machining
wood, plastic and
aluminium

Everything started in 1961...

...first as a contract turnery in the parental home in Oberkochen, founded by Reinhold and Karl Fischer, master mechanical engineer and master turner, and then gradually growing so as to offer its own production for the manufacture of shank-mounted tools for machining wood, plastic and aluminium.

In order to meet the increased need for space, the business moved to the newly constructed company building in Aalen-Niesitz in 1971.

For more than 50 years now in its second generation, precision tools in HS and TC for professional trade and industrial applications have been manufactured here under the registered brand name



and sold mainly in Germany and Europe but also worldwide.

The use of most different machinery and machinery elements and the processing of plastics, aluminium, highly diverse types of wood and materials that have little to do with the original wood material require the tool to be of the highest quality and constantly enhanced, customised for demanding applications.

All production steps from the raw material to the ready-to-sell tool have always been carried out in-house. Only the heat treatment is performed externally by regional partners. We source our raw materials exclusively from Germany and other EU countries and pay strict attention to compliance with our quality requirements here as well.

Needless to say, our tools meet the requirements of the trade association and the standards of national and European associations.

We also care much about our environment, so we are constantly working to further minimise resource consumption and our ecological footprint.

The name NAPOLEON is well known, and as our estimated customers always assure us, stands for quality, services and dependability „Made in Germany“.

We continue to adhere to the principle:
We don't seek to be one of the largest but would like to be one of the best in terms of quality and commitment.

The whole NAPOLEON team is happy to be there for you!

Reese + Fischer GmbH + Co. KG
NAPOLEON-WERKZEUGE

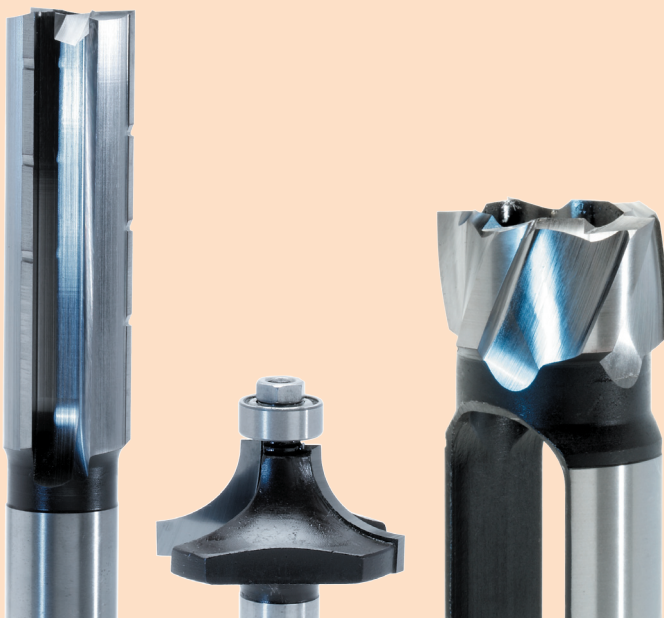

ADAPTOR 11 • 20 • 107-108 • 111
 ARBOR..... 71

BALL BEARING 69-70 • 84 • 93 • 96 • 103-106
 BEVEL CUTTER..... 73-76 • 78-84
 BEVELLING CUTTER..... 73-76 • 78-84
 BEVEL TRIMMING CUTTER 78-79

CHUCK 11 • 20 • 107-108 • 111
 CLASSIC COVE CUTTER..... 94-96
 COLLET 107
 COLLET CHUCK..... 11 • 20 • 107-108
 CONCAVE CUTTER 89-93
 CORE BOX CUTTER 89-93
 COUNTERSINK..... 40-43
 CUTTER 35-39 • 44-106
 CYLINDER BORING BIT 13 • 19 • 31-33

DECORATIVE GROOVE CUTTER 72
 DOVETAIL CUTTER..... 85-88
 DOWEL DRILL 4-10 • 12 • 14-18 • 21-30
 DRILL 4-10 • 12-19 • 21-39

ENGRAVING CUTTER 73-74
 EXTENSION..... 109-110

FLUSH CUTTER 62-63 • 67-70 • 78-79
 FORSTNER BIT 13 • 19 • 31-33

GROOVING CUTTER..... 35-39 • 44-61 • 64-65 • 71-77
 GROOVING SAW 71

HANDLE DRILL 12-19 • 24-30
 HINGE BORING BIT..... 33
 HOLLOW CUTTER..... 89-93
 HOLLOW SECTION TWIST DRILL..... 22

LOCKSET CUTTER 38 • 47-49 • 77
 LOOSE COUNTERSINK 41-43

MILLING CUTTER..... 77

OVOLO CUTTER 97-98 • 101-106

PLUG CUTTER 34
 PRECISION COLLET CHUCK 108
 PROFILE CUTTER 94-96

QUADRO HANDLE DRILL..... 28

REBATE CUTTER 66
 REBATING CUTTER..... 66
 RECIPROCATING SLOT MORTISE BIT..... 39
 ROUNDING CUTTER 97-100 • 103-106
 ROUNDING OVER CUTTER..... 97-100 • 103-106
 ROUTER 35-39 • 44-106
 ROUTER CUTTER..... 51-52

SINKER 40-43
 SLOT MORTISE BIT 35-39
 SPECIAL STEPPED DRILL..... 23
 SQUARE TRIMMING CUTTER..... 62-63 • 67-70
 STEPPED CUTTER..... 64-65
 STEPPED DRILL 15 • 23 • 25 • 27-28
 STOCKADE DRILL 9

THREAD REDUCTION 111
 TRIMMING CUTTER..... 62-63 • 67-70 • 78-79
 TWIST DRILL..... 4-10 • 12 • 14-18 • 21-30

V-GROOVING CUTTER 75-76

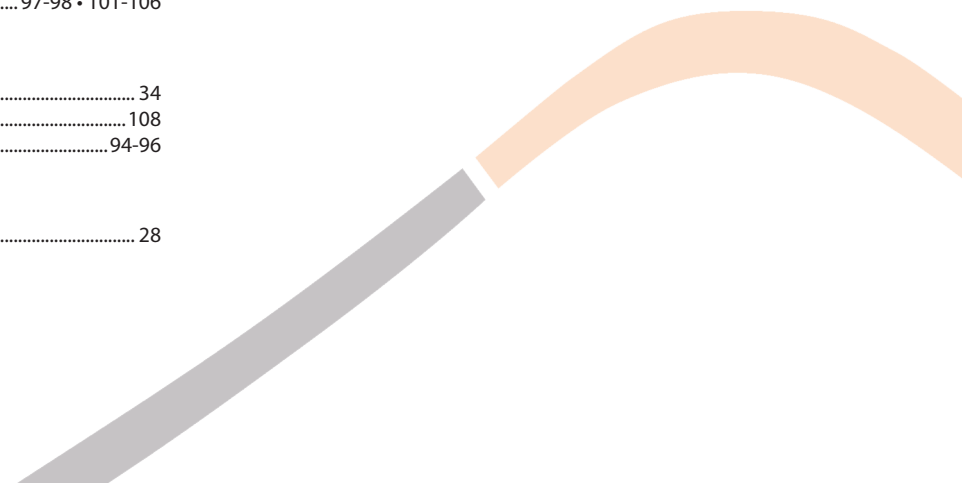

100 69-70 • 84 • 93 • 96 • 103-106

202 22
 203 4
 205 5
 208 6
 210 7
 213 8
 218 9
 250 40

310-2 11
 310-6 20
 315-0 107
 315-6 107
 318-6 109
 318-9 110
 320 111
 321 111
 322 111
 323 111
 326 111
 350 10
 375 41
 380 42
 390 43

406-2 13
 406-8 19
 410-2 12
 410-4 16
 410-6 21
 451-1 30
 460-8 17
 461-8 29
 463-8 18
 469-8 19
 471-2 24
 472-2 25
 473-2 14
 477-2 15
 479-2 13
 491-4 26
 492-4 27
 494-4 28

500 32
 505 31
 520 34
 530-12 33

607 47-49
 620 51
 625 51
 630 52
 631 52
 640-6 53
 641-6 54
 642-9 58
 643-9 56
 644-9 57
 645-9 59
 650-16 60
 651-6 55
 651-16 61

6105 47
 6106 48
 6107 49

6202 50

6602 44
 6610 75
 6611 73
 6614 67
 6618 89
 6620 62
 6621 78
 6622 80
 6625 97
 6630 85
 6632 87
 6640 71
 6641 71
 6645 71
 6650 82
 6654 99
 6656 101
 6658 91
 6659 94
 6670 69
 6671 71
 6672 84
 6676 103

6804 45
 6809 46
 6810 76
 6811 74
 6814 68
 6817 72
 6818 90
 6820 63
 6821 79
 6822 81
 6825 98
 6830 86
 6832 88
 6841 71
 6850 83
 6852 66
 6854 100
 6856 102
 6858 92
 6859 95
 6860 64
 6870 70
 6871 71
 6876 104
 6877 93
 6879 96

6971-6 71
 6976-6 105
 6976-9 106

706 77
 760 65
 7160 65
 7260 65
 7280 23
 7315-6 108
 7806 77
 7860 65

910 39
 911 39
 912 39
 913 39
 914 39
 918 38
 920 36
 921 37
 923 35

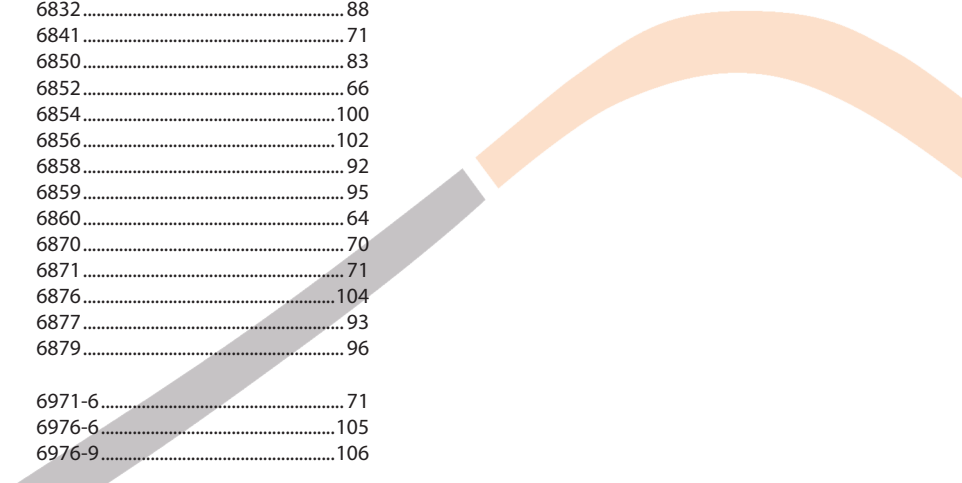

α	angle in °
AB	guide pin
AG	external thread
AL	adjusting length
AR	guide ring
AZ	guide pin
B	width
d	diameter • inner diameter • bore
D	diameter
DF	V-point
E	length adjusting screw
GL	total length
HS	high alloy high speed steel
HW	tungsten carbide
IG	internal thread
K	cone
KL	ball bearing
L	length
LD	left spiral
LH	left-hand rotation
li	left-hand rotation
LL	left cut
M	metric thread
MAN	manual feed
MEC	mechanical feed
n	revolutions per minute
NB	ream
NL	working length
P	register
PU	packing unit
r	radius
RD	right spiral
re	right-hand rotation
RH	right-hand rotation
RL	right cut
RPM	revolutions per minute
S	shank
SFI	driving flat
SL	length of shank
SP	high alloy tool steel
STC	solid tungsten carbide
SW	spanner size
TC	tungsten carbide
TiAlN	titanium aluminium nitride
TiN	titanium nitride
TS	high alloy tool steel
U	revolutions
UPVC	unplasticized polyvinyl chloride = hard type of plastic
V	spur
VB	pilot
VE	packing unit
VHW	solid tungsten carbide
Z	number of teeth
Zsp.	center point
zyl.	cylindrical

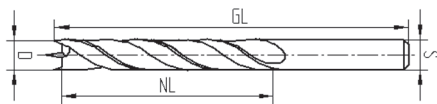

two cutting edges • center point and spurs •
RH or LH rotation • common shank and drilling diameter

for drilling blind holes and through holes in softwood and
hardwood on portable boring machines etc.

HS	D	NL	GL	S	Part number	
					LH	RH
3	33	58	3	-	203.030.000.HS.R	
3,5	39	67	3,5	-	203.035.000.HS.R	
4	43	72	4	-	203.040.000.HS.R	
4,5	47	77	4,5	203.045.000.HS.L	203.045.000.HS.R	
5	52	83	5	-	203.050.000.HS.R	
6	57	90	6	-	203.060.000.HS.R	
7,5	69	105	7,5	203.075.000.HS.L	203.075.000.HS.R	
8	75	113	8	203.080.000.HS.L	203.080.000.HS.R	
8,5	75	113	8,5	-	203.085.000.HS.R	

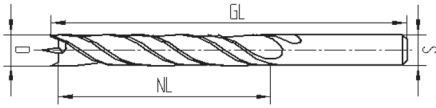

two cutting edges • center point and spurs •
RH rotation • common shank and drilling diameter

for drilling blind holes and through holes
on portable boring machines etc.

for softwood

TS	<i>D</i>	<i>NL</i>	<i>GL</i>	<i>S</i>	<i>Part number RH</i>
	7	70	110	7	205.070.000.SP.R
	9	80	130	9	205.090.000.SP.R
	12	100	155	12	205.120.000.SP.R

for soft- and hardwood • landed flute • particularly suited for precise holes

HS	<i>D</i>	<i>NL</i>	<i>GL</i>	<i>S</i>	<i>Part number RH</i>
	8,5	55	90	8,5	205.08555.0090.HS.R
	14	155	220	14	205.14015.0022.HS.R

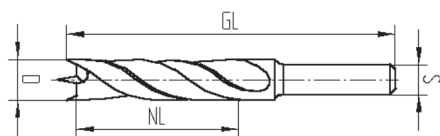

two cutting edges • center point and spurs •
RH rotation • stepped parallel shank 8x30 mm

for use on portable boring machines etc.

for softwood

TS	D	NL	GL	S	Part number RH
	8	65	100	8x30	208.080.000.SP.R
	18	65	100	8x30	208.180.000.SP.R

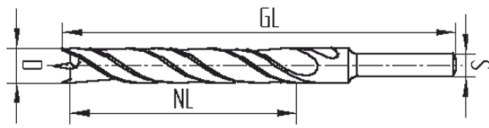

two cutting edges • center point and spurs •
RH rotation • stepped parallel shank 10 mm

for use on portable boring machines etc.

for softwood

TS	<i>D</i>	<i>NL</i>	<i>GL</i>	<i>S</i>	<i>Part number RH</i>
	18	100	140	10x30	210.180.000.SPR

for soft- and hardwood • landed flute • particularly suited for precise holes

HS	<i>D</i>	<i>NL</i>	<i>GL</i>	<i>S</i>	<i>Part number RH</i>
	9	80	120	10x25	210.09080.0012.HS.R
	12	135	175	10x30	210.12013.0017.HS.R
	14	180	210	10x30	210.14018.0021.HS.R

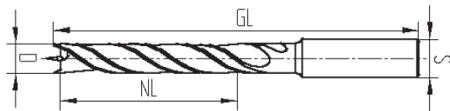

two cutting edges • center point and spurs •
RH or LH rotation • stepped parallel shank

for use on portable and upright boring machines etc.

for softwood

TS	D	NL	GL	S	Part number	Part number
					LH	RH
	7	80	145	13x50	213.070.000.SP.L	213.070.000.SP.R
	8	85	150	13x50	213.080.000.SP.L	-
	10	95	160	13x50	-	213.100.000.SP.R
	12	105	170	13x50	-	213.120.000.SP.R
	14	115	180	13x50	-	213.140.000.SP.R
	15	120	185	13x50	213.150.000.SP.L	-
	18	130	200	16x50	213.180.000.SP.L	213.180.000.SP.R
	20	140	210	16x50	-	213.200.000.SP.R

for soft- and hardwood • landed flute • particularly suited for precise holes

HS	D	NL	GL	S	Part number	Part number
					LH	RH
	13	110	175	13x50	213.130.000.HS.L	-
	20	45	110	13x50	-	213.200.450.HS.R
	24	160	235	13x50	-	213.240.130.HS.R

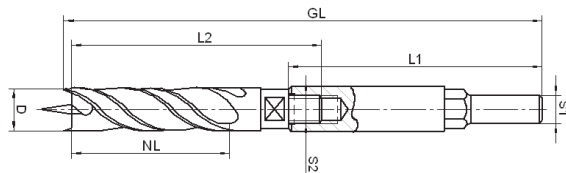
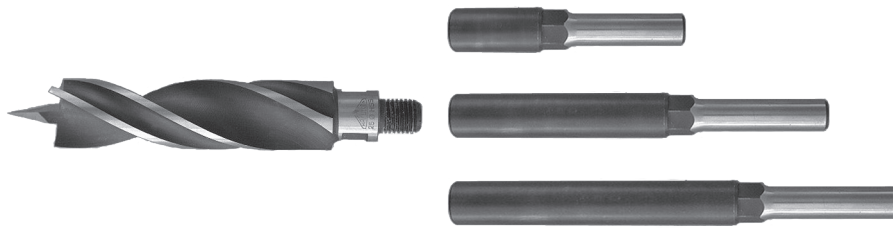

The practical alternative:
two-parts • available in three different lengths

stockade drill •
extra long center point and spurs •
landed flute • RH rotation
+
extension in requested length •
stepped parallel shank 13 mm

especially suited for precise inclined drilling (stockade holes)
in softwood and hardwood in stair production etc.
on drilling attachments for stockade holes
e. g. Bohrfix • Bohrluchs

stockade drill

HS	D	NL	L2	S2	Part number RH
	20	100	125	AG M12	218.200.100.HS.R
	25	100	125	AG M12	218.250.100.HS.R
	30	100	125	AG M12	218.300.100.HS.R

extension • extensions with driving flat on shank are available optionally without extra charge

L1	for GL	S1	Part number RH
70	180	13x40	218.000.070.SM.R
160	270	13x50	218.000.160.SM.R
190	300	13x50	218.000.190.SM.R

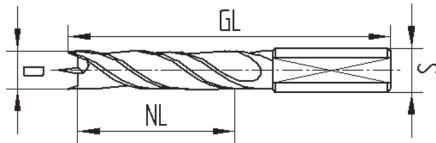

two cutting edges • center point and spurs • landed flute •
RH or LH rotation • shank 10 mm with driving flat •
no length adjusting screw

particularly suited for precise holes in softwood and
hardwood in collet chucks on dowel drill and CNC machines

working length 30 mm • total length 57 mm

HS	D	NL	GL	S	Part number	Part number
					LH	RH
	5	30	57	10x20	350.050.300.HS.L	350.050.300.HS.R
	6	30	57	10x20	350.060.300.HS.L	350.060.300.HS.R
	8	30	57	10x20	-	350.080.300.HS.R
	10	30	57	10x20	350.100.300.HS.L	350.100.300.HS.R
	12	30	57	10x20	350.120.300.HS.L	350.120.300.HS.R

working length 40 mm • total length 67 mm

HS	D	NL	GL	S	Part number	Part number
					LH	RH
	5	40	67	10x20	350.050.400.HS.L	350.050.400.HS.R
	6	40	67	10x20	350.060.400.HS.L	350.060.400.HS.R
	8	40	67	10x20	350.080.400.HS.L	350.080.400.HS.R
	12	40	67	10x20	350.120.400.HS.L	-

working length 45 mm • total length 85 mm

HS	D	NL	GL	S	Part number	Part number
					LH	RH
	5	45	85	10x30	350.050.450.HS.L	-
	6	45	85	10x30	350.060.450.HS.L	-
	8	45	85	10x30	350.080.450.HS.L	350.080.450.HS.R
	10	45	85	10x30	350.100.450.HS.L	-
	12	45	85	10x30	350.120.450.HS.L	-

working length 60 mm • total length 95 mm

HS	D	NL	GL	S	Part number	Part number
					LH	RH
	6	60	95	10x25	350.060.600.HS.L	-
	8	60	95	10x25	350.080.600.HS.L	-
	10	60	95	10x25	-	350.100.600.HS.R

working length 65 mm • total length 105 mm

HS	D	NL	GL	S	Part number	Part number
					LH	RH
	5	65	105	10x30	350.050.650.HS.L	-
	6	65	105	10x30	350.060.650.HS.L	-
	8	65	105	10x30	-	350.080.650.HS.R
	10	65	105	10x30	-	350.100.650.HS.R
	12	65	105	10x30	350.120.650.HS.L	350.120.650.HS.R

working length 85 mm • total length 120 mm

HS	D	NL	GL	S	Part number	Part number
					LH	RH
	10	85	120	10x25	350.100.850.HS.L	-
	12	85	120	10x25	350.120.850.HS.L	-
	16	85	120	10x25	350.160.850.HS.L	350.160.850.HS.R

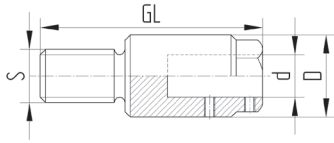

shank external thread M10 • inner diameter 10 mm •
outer diameter 19 mm • RH or LH rotation •
two cramping screws

for use with dowel drills and cylinder boring bits with
shank 10 mm

for e. g. Ayen • Holzma • Knoevenagel • Mayer • Torwegge

<i>S</i>	<i>d</i>	<i>GL</i>	<i>Part number LH</i>	<i>Part number RH</i>
AG M10	10	40	310-2.100.000.SM.L	310-2.100.000.SM.R
AG M10	10	46	310-2.100.460.SM.L	310-2.100.460.SM.R
AG M10	10	50	310-2.100.500.SM.L	310-2.100.500.SM.R

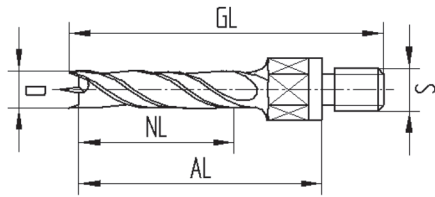

two cutting edges • center point and spurs • landed flute •
RH or LH rotation • shank external thread M10

particularly suited for precise holes in softwood and
hardwood on e. g. Ayen • Haffner • Holzma • Knoevenagel •
Mayer • Pertici • Striffler • Torwegge

working length 45 mm • adjusting length 63 mm

HS	D	NL	AL	GL	S	Part number LH	Part number RH
	5	45	63	78	AG M10	-	410-2.050.450.HS.R
	6	45	63	78	AG M10	410-2.060.450.HS.L	410-2.060.450.HS.R
	8	45	63	78	AG M10	410-2.080.450.HS.L	-
	10	45	63	78	AG M10	410-2.100.450.HS.L	410-2.100.450.HS.R
	12	45	63	78	AG M10	410-2.120.450.HS.L	410-2.120.450.HS.R
	20	45	63	78	AG M10	410-2.200.450.HS.L	-
	22	45	63	78	AG M10	410-2.220.450.HS.L	-

working length 50 mm • adjusting length 68 mm

HS	D	NL	AL	GL	S	Part number LH	Part number RH
	7	50	68	83	AG M10	410-2.070.500.HS.L	410-2.070.500.HS.R
	8	50	68	83	AG M10	410-2.080.500.HS.L	410-2.080.500.HS.R
	13	50	68	83	AG M10	410-2.130.500.HS.L	-
	14	50	68	83	AG M10	-	410-2.140.500.HS.R
	17	50	68	83	AG M10	-	410-2.170.500.HS.R

working length 60 mm • adjusting length 78 mm

HS	D	NL	AL	GL	S	Part number LH	Part number RH
	10	60	78	93	AG M10	410-2.100.600.HS.L	410-2.100.600.HS.R
	14	60	78	93	AG M10	410-2.140.600.HS.L	-

working length 70 mm • adjusting length 88 mm

HS	D	NL	AL	GL	S	Part number LH	Part number RH
	5	70	88	103	AG M10	-	410-2.050.700.HS.R

working length 80 mm • adjusting length 98 mm

HS	D	NL	AL	GL	S	Part number LH	Part number RH
	8	80	98	113	AG M10	410-2.080.800.HS.L	410-2.080.800.HS.R
	10	80	98	113	AG M10	410-2.100.800.HS.L	410-2.100.800.HS.R
	13	80	98	113	AG M10	410-2.130.800.HS.L	-

working length 100 mm • adjusting length 118 mm

HS	D	NL	AL	GL	S	Part number LH	Part number RH
	11	100	118	133	AG M10	410-2.110.001.HS.L	-
	14	100	118	133	AG M10	410-2.140.001.HS.L	-
	16	100	118	133	AG M10	-	410-2.160.001.HS.R

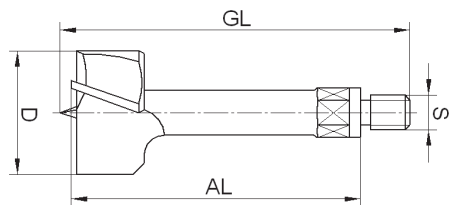

two cutting edges • center point and spurs •
RH (two-part) or LH rotation • shank external thread M10

for drilling handles in soft- and hardwood
on e. g. Ayen • Haffner • Mayer • Pertici • Striffler

HS	D	AL	GL	S	Part number	Part number
					LH	RH
	25	68	87	AG M10	479-2.250.000.HS.L	406-2.250.000.HS.R

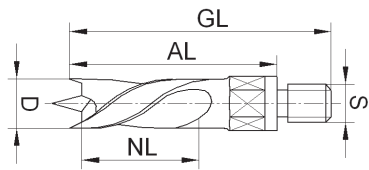

two cutting edges • enforced center point and spurs •
landed flute • LH rotation • shank external thread M10

particularly for precise drilling of handles in soft- and
hardwood on e. g. Ayen • Haffner • Mayer • Pertici • Striffler

HS	D	NL	AL	GL	S	Part number LH
	10	20	44	59	AG M10	473-2.100.000.HS.L
	12	20	44	59	AG M10	473-2.120.000.HS.L

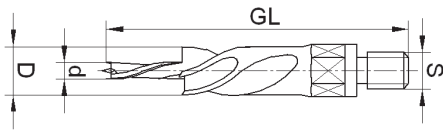
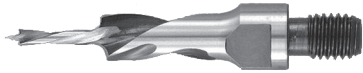

two cutting edges • pilot drill with center point and spurs •
LH rotation • shank external thread M10

for drilling handles in soft- and hardwood
on e. g. Ayen • Haffner • Mayer • Pertici • Striffler

HS	D	d	GL	S	Part number LH
	10	3,5x18	72	AG M10	477-2.035.100.HS.L

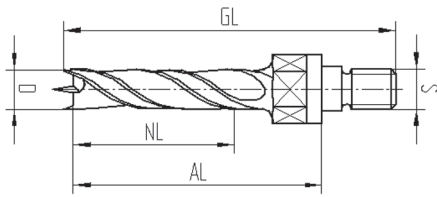

two cutting edges • center point and spurs •
landed flute • RH or LH rotation •
shank external thread M10 and register 11x4 mm

particularly suited for precise holes in softwood and
hardwood on e. g. Biesse • Bussellato • Morbidelli •
Torwegge • Weeke

HS	D	NL	AL	GL	S	Part number	Part number
						LH	RH
	6	45	62	78	AG M10+P	410-4.060.450.HS.L	410-4.060.450.HS.R
	8	45	62	78	AG M10+P	-	410-4.080.450.HS.R
	18	45	62	78	AG M10+P	410-4.180.450.HS.L	-

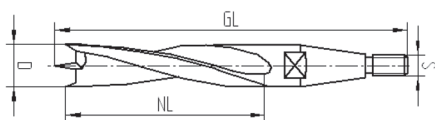

two cutting edges • center point and spurs •
RH rotation • shank external thread M6 and cone 16°

for drilling handles in softwood
on e. g. Notter • Striffler

TS	D	NL	GL	S	Part number RH
	6	45	87	AG M6+K	460-8.060.000.SP.R
	8	45	87	AG M6+K	460-8.080.000.SP.R
	8,5	45	87	AG M6+K	460-8.085.000.SP.R
	9	45	87	AG M6+K	460-8.090.000.SP.R
	14	45	87	AG M6+K	460-8.140.000.SP.R
	15	45	87	AG M6+K	460-8.150.000.SP.R
	16	45	87	AG M6+K	460-8.160.000.SP.R



two cutting edges • enforced center point and spurs •
RH rotation • shank external thread M6 and cone 16°

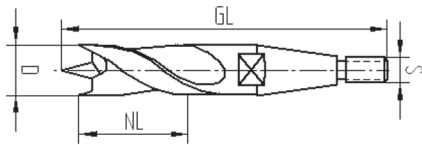

for drilling handles in softwood
on e. g. Notter • Striffler

TS	D	NL	GL	S	Part number RH
	10	20	63	AG M6+K	463-8.100.000.SP.R
	12	20	63	AG M6+K	463-8.120.000.SP.R

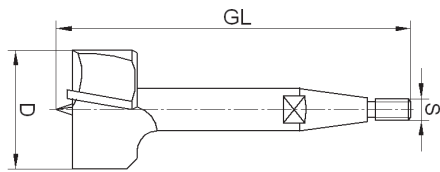

two cutting edges • center point and spurs •
RH rotation • shank external thread M6 and cone 16°

for drilling handles in softwood
on e. g. Notter • Striffler

TS	D	GL	S	Part number RH
	30	87	AG M6+K	469-8.300.000.SP.R

two-part

HS	D	GL	S	Part number RH
	25	87	AG M6+K	406-8.250.000.HS.R

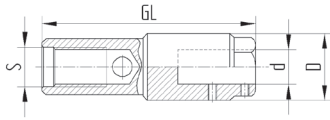

shank internal thread M10 • inner diameter 10 mm •
outer diameter 19 mm • RH or LH rotation •
two crampling screws

for use with dowel drills and cylinder boring bits with
shank 10 mm

further inner diameters on inquiry

for e. g. Häfele • Scheer

<i>S</i>	<i>d</i>	<i>GL</i>	<i>Part number LH</i>	<i>Part number RH</i>
IG M10	10	46	310-6.100.000.SM.L	310-6.100.000.SM.R

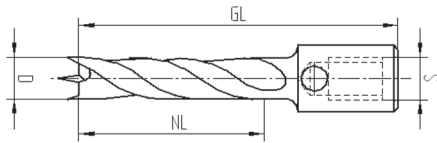
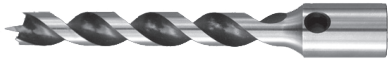

two cutting edges • center point and spurs •
RH or LH rotation • shank internal thread M10

for working softwood and hardwood
on e. g. Häfele • Scheer

working length 47 mm • total length 80 mm

HS	D	NL	GL	S	Part number	Part number
					LH	RH
5	5	47	80	IG M10	410-6.050.470.HS.L	-
6	6	47	80	IG M10	410-6.060.470.HS.L	410-6.060.470.HS.R
8	8	47	80	IG M10	410-6.080.470.HS.L	410-6.080.470.HS.R
9	9	47	80	IG M10	410-6.090.470.HS.L	-
10	10	47	80	IG M10	410-6.100.470.HS.L	410-6.100.470.HS.R
11	11	47	80	IG M10	-	410-6.110.470.HS.R
12	12	47	80	IG M10	-	410-6.120.470.HS.R
13	13	47	80	IG M10	-	410-6.130.470.HS.R
14	14	47	80	IG M10	410-6.140.470.HS.L	410-6.140.470.HS.R
15	15	47	80	IG M10	410-6.150.470.HS.L	410-6.150.470.HS.R
16	16	47	80	IG M10	410-6.160.470.HS.L	410-6.160.470.HS.R
18	18	47	80	IG M10	-	410-6.180.470.HS.R

working length 80 mm • total length 105 mm

HS	D	NL	GL	S	Part number	Part number
					LH	RH
8	8	80	105	IG M10	410-6.080.800.HS.L	410-6.080.800.HS.R
10	10	80	105	IG M10	410-6.100.800.HS.L	410-6.100.800.HS.R
12	12	80	105	IG M10	410-6.120.800.HS.L	410-6.120.800.HS.R
14	14	80	105	IG M10	410-6.140.800.HS.L	410-6.140.800.HS.R
15	15	80	105	IG M10	-	410-6.150.800.HS.R
16	16	80	105	IG M10	410-6.160.800.HS.L	410-6.160.800.HS.R



two cutting edges • V-point • extremely short spiral drill part •
RH rotation • common shank and drilling diameter

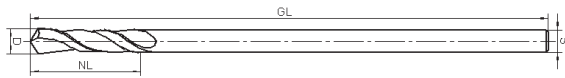

designed for drilling steel profile sheet constructions
and hollow sections made of UPVC and aluminium

HS	D	NL	S	GL	Part number
					RH
5	30	30	5	150	202.050.150.HS.R
				180	-
6	30	30	6	150	202.060.150.HS.R
				180	202.060.180.HS.R
7	30	30	7	150	202.070.150.HS.R
				180	-
10	30	30	10	150	202.100.150.HS.R
				180	-

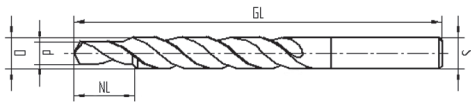

two cutting edges • V-point • two-stage • RH rotation • parallel shank

designed for efficient production of bore and countersink at one workstep in aluminium and UPVC profiles etc. on copying machines, boring machines, etc.

countersink 180° • recommended for socket head screws

HS	d	NL	D	GL	S	Part number RH
	4,3	11	8	117	8	7280.043.080.HS.R
	5,3	13	10	133	10	7280.053.100.HS.R
	6,4	15	12	142	12	7280.064.120.HS.R
	7	10	10	123	10	7280.100.650.HS.R
	7	11	10	148	10	7280.100.900.HS.R

countersink 90° • recommended for countersunk screws

HS	d	NL	D	GL	S	Part number RH
	4,3	11	8	117	8	7280.043.900.HS.R
	5,3	13	10	133	10	7280.053.900.HS.R

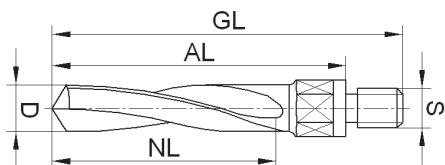

two cutting edges • V-point • RH or LH rotation •
shank external thread M10

for drilling handles in UPVC profiles with or
without steel insert and aluminium profiles
on e. g. Ayen • elumatec • Haffner • Mayer • Pertici •
Rotox • Striffler

by request also available in coated design

HS	D	NL	AL	GL	S	Part number	Part number
						LH	RH
10	100	118	133	AG M10	471-2.100.133.HS.L	-	
12	30	52	67	AG M10	471-2.120.067.HS.L	-	
12	33	55	70	AG M10	-	471-2.120.070.HS.R	
12	30	57	72	AG M10	471-2.120.072.HS.L	-	
12	63	85	100	AG M10	471-2.120.100.HS.L	471-2.120.100.HS.R	
13	30	57	72	AG M10	471-2.130.072.HS.L	-	
13	35	61	76	AG M10	-	471-2.130.076.HS.R	

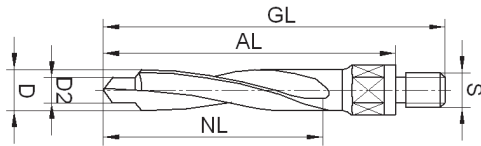

two cutting edges • V-point and pilot 6x5 mm •
RH or LH rotation • shank external thread M10

for drilling handles in UPVC profiles with or
without steel insert and aluminium profiles
on e. g. Ayen • elumatec • Haffner • Mayer • Pertici •
Rotox • Striffler

by request also available in coated design

HS	D	D2	NL	AL	GL	S	Part number	Part number
							LH	RH
	10	6	35	57	72	AG M10	472-2.100.072.HS.L	-
	10	6	50	69	84	AG M10	472-2.100.084.HS.L	-
	10	6	65	85	100	AG M10	472-2.100.100.HS.L	472-2.100.100.HS.R
	12	6	35	61	76	AG M10	-	472-2.120.076.HS.R
	12	6	50	72	87	AG M10	-	472-2.120.087.HS.R
	12	6	53	75	90	AG M10	472-2.120.090.HS.L	472-2.120.090.HS.R
	12	6	65	85	100	AG M10	472-2.120.100.HS.L	472-2.120.100.HS.R
	14	6	50	69	84	AG M10	472-2.140.084.HS.L	-

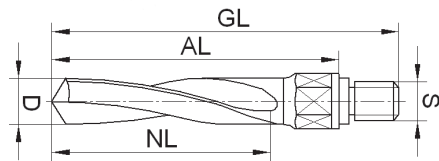

two cutting edges • V-point • RH or LH rotation •
shank external thread M10 and register 11x4 mm

for drilling handles in UPVC profiles with or
without steel insert and aluminium profiles
on e. g. elumatec • Federhenn • Pertici

total length RH 83 mm / LH 80 mm

HS	D	NL	AL	GL	S	Part number	Part number
						LH	RH
10	45	64	83	AG M10+P	-	491-4.100.000.HS.R	
10	45	61	80	AG M10+P	491-4.100.000.HS.L	-	
12	45	61	80	AG M10+P	491-4.120.000.HS.L	-	
14	45	64	83	AG M10+P	-	491-4.140.000.HS.R	
14	45	61	80	AG M10+P	491-4.140.000.HS.L	-	

total length 90 mm

HS	D	NL	AL	GL	S	Part number	Part number
						LH	RH
10	55	71	90	AG M10+P	-	491-4.100.550.HS.R	
12	55	71	90	AG M10+P	491-4.120.550.HS.L	491-4.120.550.HS.R	

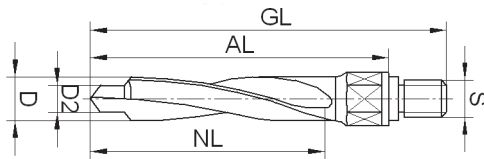

two cutting edges • V-point and pilot 6x5 mm •
RH or LH rotation •
shank external thread M10 and register 11x4 mm

for drilling handles in UPVC profiles with or
without steel insert and aluminium profiles
on e. g. elumatec • Federhenn • Pertici

HS	D	D2	NL	AL	GL	S	Part number	Part number
							LH	RH
	12	6	50	68	87	AG M10+P	492-4.120.000.HS.L	-
	14	6	50	68	87	AG M10+P	492-4.140.000.HS.L	492-4.140.000.HS.R

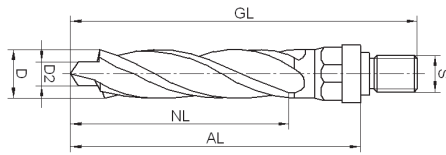

four cutting edges • V-point and pilot 6x5 mm •
RH or LH rotation •
shank external thread M10 and register 11x4 mm

for drilling handles in UPVC profiles with or
without steel insert and aluminium profiles
on e. g. elumatec • Federhenn • Pertici

HS	D	D2	NL	AL	GL	S	Part number LH	Part number RH
	10	6	55	71	90	AG M10+P	-	494-4.100.554.HS.R
12	6	55	71	90	AG M10+P	494-4.120.554.HS.L	494-4.120.554.HS.R	

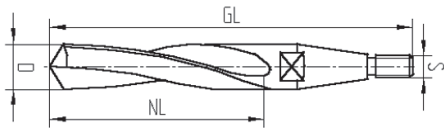
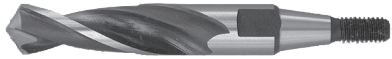

two cutting edges • V-point • RH rotation •
shank external thread M6 and cone 16°

for drilling handles in UPVC profiles with or
without steel insert and aluminium profiles
on e. g. Notter • Striffler

HS	D	NL	GL	S	Part number RH
	8	45	87	AG M6+K	461-8.080.000.HS.R
	9	45	87	AG M6+K	461-8.090.000.HS.R
	12	45	87	AG M6+K	461-8.120.000.HS.R
	14	45	87	AG M6+K	461-8.140.000.HS.R
	18	45	87	AG M6+K	461-8.180.000.HS.R

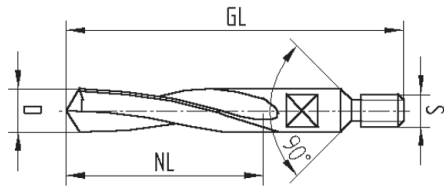

two cutting edges • V-point • RH or LH rotation •
shank external thread M8 and cone 90°

for drilling handles in UPVC profiles with or
without steel insert and aluminium profiles
on e. g. Wegoma

total length 78 mm

HS	D	NL	GL	S	Part number	Part number
					LH	RH
10	10	50	78	AG M8+K	451-1.100.000.HS.L	-
12	12	50	78	AG M8+K	-	451-1.120.000.HS.R
14	14	50	78	AG M8+K	451-1.140.000.HS.L	451-1.140.000.HS.R
16	16	50	78	AG M8+K	451-1.160.000.HS.L	-

total length 90 mm

HS	D	NL	GL	S	Part number	Part number
					LH	RH
10	10	62	90	AG M8+K	451-1.100.900.HS.L	-
12	12	62	90	AG M8+K	-	451-1.120.900.HS.R



two cutting edges • center point and spurs •
RH rotation • stepped parallel shank 10 mm

to produce tear free bore holes in softwood
on e. g. portable and stationary boring machines

TS	D	GL	S	Part number RH
	8	90	10	505.080.000.WS.R
	15	90	10	505.150.000.WS.R
	16	90	10	505.160.000.WS.R
	18	90	10	505.180.000.WS.R
	19	90	10	505.190.000.WS.R
	22	90	10	505.220.000.WS.R
	23	90	10	505.230.000.WS.R
	25	90	10	505.250.000.WS.R
	26	90	10	505.260.000.WS.R
	28	90	10	505.280.000.WS.R
	30	90	10	505.300.000.WS.R
	34	90	10	505.340.000.WS.R
	35	90	10	505.350.000.WS.R
	38	90	10	505.380.000.WS.R
	45	90	10	505.450.000.WS.R

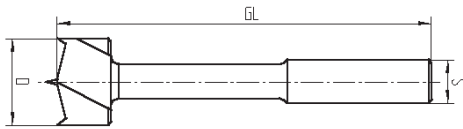

two cutting edges • center point and spurs •
RH rotation • stepped parallel shank

to produce tear free bore holes in softwood
on e. g. portable and stationary boring machines

TS	D	GL	S	Part number RH
	8	120	13	500.080.000.WS.R
	10	120	13	500.100.000.WS.R
	12	125	13	500.120.000.WS.R
	15	125	13	500.150.000.WS.R
	20	130	13	500.200.000.WS.R
	22	130	13	500.220.000.WS.R
	24	135	13	500.240.000.WS.R
	25	135	13	500.250.000.WS.R
	26	135	13	500.260.000.WS.R
	28	140	13	500.280.000.WS.R
	34	140	16	500.340.000.WS.R
	35	140	16	500.350.000.WS.R
	36	140	16	500.360.000.WS.R
	38	140	16	500.380.000.WS.R
	40	140	16	500.400.000.WS.R
	42	140	16	500.420.000.WS.R
	45	140	16	500.450.000.WS.R
	52	140	16	500.520.000.WS.R
	55	140	16	500.550.000.WS.R
	60	140	16	500.600.000.WS.R
	65	140	16	500.650.000.WS.R
	75	160	20	500.750.000.WS.R
	80	140	20	500.800.000.WS.R

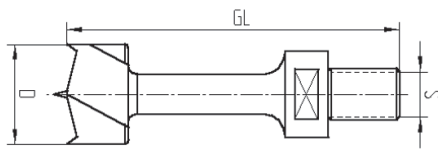

two cutting edges • center point and spurs •
RH rotation • shank external thread M12

to produce hinge holes and handle holes etc.
in softwood on e. g. Rapid

TS	D	GL	S	Part number RH
	15	85	AG M12	530-12.150.000.SP.R
	20	85	AG M12	530-12.200.000.SP.R
	30	85	AG M12	530-12.300.000.SP.R
	35	85	AG M12	530-12.350.000.SP.R



either four or six cutting edges and periphery cutting edge •
RH rotation • stepped parallel shank

to produce plugs, tenors, etc. in softwood
on e. g. stationary boring machines

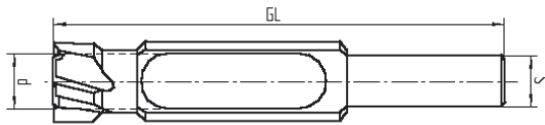

TS	d	Z	GL	S	Part number RH
	8	4	140	13	520.080.000.WS.R
	14	4	140	13	520.140.000.WS.R
	16	4	140	13	520.160.000.WS.R
	18	4	140	13	520.180.000.WS.R
	34	6	140	13	520.340.130.WS.R
	34	6	140	16	520.340.000.WS.R
	35	6	140	13	520.350.130.WS.R
	40	6	140	13	520.400.130.WS.R
	40	6	140	16	520.400.000.WS.R
	45	6	140	13	520.450.130.WS.R
	45	6	140	16	520.450.000.WS.R

fitted

HS	d	Z	GL	S	Part number RH
	8	4	140	13	520.080.000.HS.R
	12	4	140	13	520.120.000.HS.R

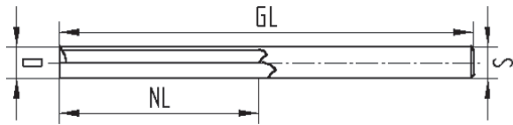

two straight cutting edges • RH rotation •
common shank and drilling diameter

for cutting mortise slots etc. in softwood
on e. g. mortise slot machines

TS	D	NL	GL	Z	S	Part number
						RH
	6	35	110	2	6	923.060.000.SP.R
	7	40	115	2	7	923.070.000.SP.R
	9	48	125	2	9	923.090.000.SP.R
	11	50	135	2	11	923.110.000.SP.R
	12	55	140	2	12	923.120.000.SP.R

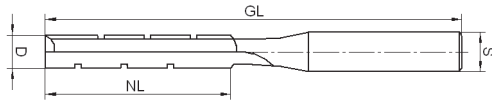

two straight cutting edges • chip breaking grooves •
RH or LH rotation • stepped parallel shank

for cutting mortise slots etc. in softwood
on e. g. mortise slot machines

shank 13x50 mm

TS	D	NL	GL	Z	S	Part number	Part number
						LH	RH
	5	34	115	2	13	920.050.130.SP.L	-
	6	36	120	2	13	920.060.130.SP.L	-
	7	38	125	2	13	920.070.130.SP.L	920.070.130.SP.R
	8	40	130	2	13	920.080.130.SP.L	-
	9	43	135	2	13	920.090.130.SP.L	920.090.130.SP.R
	10	45	140	2	13	920.100.130.SP.L	-
	11	48	145	2	13	920.110.130.SP.L	-
	13	53	155	2	13	920.130.130.SP.L	-
	14	56	160	2	13	920.140.130.SP.L	920.140.130.SP.R
	15	60	165	2	13	920.150.130.SP.L	-
	16	63	170	2	13	920.160.130.SP.L	920.160.130.SP.R
	17	67	180	2	13	920.170.130.SP.L	920.170.130.SP.R
	18	67	180	2	13	-	920.180.130.SP.R
	19	71	185	2	13	-	920.190.130.SP.R
	21	75	190	2	13	-	920.210.130.SP.R
	22	75	190	2	13	-	920.220.130.SP.R

shank 16x50 mm

TS	D	NL	GL	Z	S	Part number	Part number
						LH	RH
	6	36	120	2	16	920.060.160.SP.L	920.060.160.SP.R
	7	38	125	2	16	920.070.160.SP.L	920.070.160.SP.R
	9	43	135	2	16	920.090.160.SP.L	-
	10	45	140	2	16	920.100.160.SP.L	920.100.160.SP.R
	12	50	150	2	16	920.120.160.SP.L	-
	14	56	160	2	16	920.140.160.SP.L	-
	16	63	170	2	16	920.160.160.SP.L	-
	17	67	180	2	16	920.170.160.SP.L	-
	18	67	180	2	16	920.180.160.SP.L	-
	20	71	185	2	16	920.200.160.SP.L	-
	22	75	190	2	16	-	920.220.160.SP.R

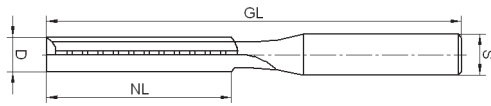

two straight cutting edges • chip breakers •
RH rotation • stepped parallel shank

for cutting mortise slots etc. in softwood
on e. g. mortise slot machines

TS	D	NL	GL	Z	S	Part number RH
	6	36	120	2	13	921.060.130.SP.R
	9	43	125	2	13	921.090.130.SP.R
	10	45	130	2	13	921.100.130.SP.R
	13	53	145	2	13	921.130.130.SP.R
	16	63	160	2	16	921.160.160.SP.R
	17	65	165	2	16	921.170.160.SP.R
	18	67	170	2	16	921.180.160.SP.R



two straight cutting edges • chip breaking grooves •
RH rotation • parallel shank 16 mm

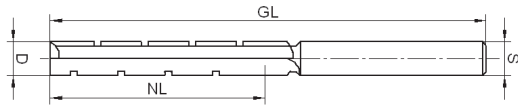

designed to rout lockset pockets in softwood
on mortise slot machines

TS	D	NL	GL	Z	S	Part number RH
	20	130	200	2	16	918.200.130.WS.R

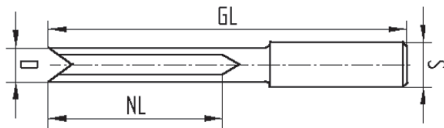

either two or four cutting edges • parallel shank

for working softwood and hardwood on e. g. special machines with reciprocating feed units

two cutting edges • common shank and drilling diameter

912	D	NL	GL	Z	S	Part number
	6	38	90	2	6	912.060.000.HS.0
	7	23	80	2	7	912.070.230.HS.0
	7	38	95	2	7	912.070.380.HS.0
	8	42	95	2	8	912.080.000.HS.0
	9	26	80	2	9	912.090.260.HS.0
	9	46	100	2	9	912.090.460.HS.0
	10	51	105	2	10	912.100.000.HS.0
	11	56	110	2	11	912.110.000.HS.0
	12	61	115	2	12	912.120.000.HS.0

two cutting edges • shank 10 mm

911	D	NL	GL	Z	S	Part number
	13	65	120	2	10	911.130.000.HS.0
	14	30	80	2	10	911.140.000.HS.0

two cutting edges • shank 13 mm

910	D	NL	GL	Z	S	Part number
	6	38	90	2	13	910.060.000.HS.0

two cutting edges • shank 16 mm

913	D	NL	GL	Z	S	Part number
	6	38	90	2	16	913.060.000.HS.0
	8	42	100	2	16	913.080.000.HS.0
	9	46	100	2	16	913.090.000.HS.0

four cutting edges

914	D	NL	GL	Z	S	Part number
	6	38	90	4	13	914.060.000.HS.0
	7	34	80	4	10	914.070.340.HS.0
	9	46	100	4	13	914.090.000.HS.0
	10	40	75	4	10	914.100.400.HS.0
	11	30	70	4	10	914.110.300.HS.0
	14	70	120	4	13	914.140.000.HS.0



two cutting edges • countersink angle 90° • RH rotation •
bore and crampling screw • stepped parallel shank

for countersinking of holes

for mounting on twist drills
e. g. like article 203 • 205

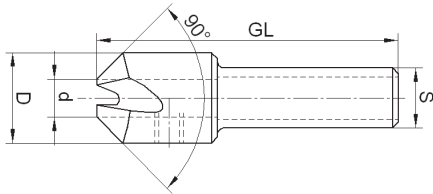

for softwood

TS	d	D	GL	S	Part number RH
	7	15	58	10x30	250.070.000.SP.R

for soft- and hardwood

HS	d	D	GL	S	Part number RH
	4	15	58	10x30	250.040.000.HS.R
	6	15	58	10x30	250.060.000.HS.R
	10	20	58	13x30	250.100.000.HS.R

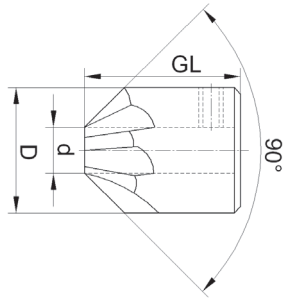

five cutting edges • countersink angle 90° •
RH rotation • bore and crampling screw

to be used in conjunction with twist drills and dowel drills

for softwood

TS	d	D	GL	Part number RH
	3,5	16	28	375.035.000.WS.R
	4,5	16	28	375.045.000.WS.R
	6,5	16	28	375.065.000.WS.R
	7	16	28	375.070.000.WS.R
	8	20	28	375.080.000.WS.R
	10	20	28	375.100.000.WS.R

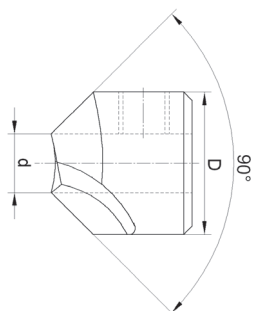
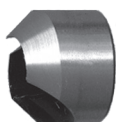

two cutting edges • countersink angle 90° •
RH or LH rotation • bore and cramping screw

to be used in conjunction with twist drills and dowel drills

for softwood and hardwood

HS	d	D	Part number LH	Part number RH
	3	16	380.030.000.HS.L	380.030.000.HS.R
	3,5	16	380.035.000.HS.L	380.035.000.HS.R
	4,5	16	-	380.045.000.HS.R
	5,5	16	380.055.000.HS.L	380.055.000.HS.R
	6	16	380.060.000.HS.L	380.060.000.HS.R
	7,5	18	380.075.000.HS.L	-
	7,5	20	380.075.200.HS.L	380.075.200.HS.R
	8	18	380.080.000.HS.L	380.080.000.HS.R
	8,5	18	380.085.000.HS.L	380.085.000.HS.R
	9	18	380.090.000.HS.L	-
	9,5	20	380.095.000.HS.L	380.095.000.HS.R
	10	20	380.100.000.HS.L	-
	11	20	380.110.000.HS.L	-
	12	20	380.120.000.HS.L	380.120.000.HS.R
	12,5	20	-	380.125.000.HS.R
	13	22	-	380.130.220.HS.R
	14	22	-	380.140.000.HS.R

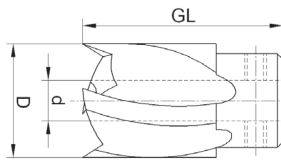

two cutting edges • countersink angle 180° •
RH rotation • bore and crampling screw

to be used in conjunction with twist drills and dowel drills

for shallow countersinks in softwood and hardwood

HS	<i>d</i>	<i>D</i>	<i>GL</i>	<i>Part number RH</i>
	6,5	15	25	390.065.150.HS.R
	8,5	20	30	390.085.200.HS.R
	9	28	25	390.090.280.HS.R
	9,5	28	25	390.095.280.HS.R
	12	28	30	390.120.280.HS.R

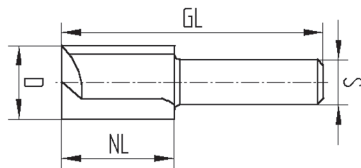
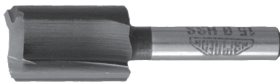

either one or two straight cutting edges •
RH rotation • parallel shank 6 mm

for use on portable and stationary routers with
concentric clamping chucks with manual feed (MAN)

for soft- and hardwood

HS	D	NL	GL	Z	S	Part number RH
	2	6	42	1	6	6602.020.060.HS.R
	3	8	42	1	6	6602.030.080.HS.R
	4	10	42	1	6	6602.040.100.HS.R
	4	10	48	2	6	6602.040.002.HS.R
	5	15	42	2	6	6602.050.150.HS.R
	6	16	44	2	6	6602.060.160.HS.R
	6	30	60	2	6	6602.060.300.HS.R
	6	30	70	2	6	6602.060.307.HS.R
	7	20	65	2	6	6602.070.200.HS.R
	8	20	48	2	6	6602.080.200.HS.R
	8	30	57	2	6	6602.080.300.HS.R
	9	20	65	2	6	6602.090.200.HS.R
	10	20	52	2	6	6602.100.200.HS.R
	10	30	57	2	6	6602.100.300.HS.R
	12	20	52	2	6	6602.120.200.HS.R
	12	30	60	2	6	6602.120.300.HS.R
	14	20	52	2	6	6602.140.200.HS.R
	14	40	66	2	6	6602.140.400.HS.R
	15	20	48	2	6	6602.150.200.HS.R
	15	25	51	2	6	6602.150.250.HS.R
	20	20	51	2	6	6602.200.200.HS.R
	22	17	48	2	6	6602.220.170.HS.R

for hardwood, wood composites and coated materials

TC	D	NL	GL	Z	S	Part number RH
	3	6	45	2	6	6602.030.060.HW.R
	5	12	60	1	6	6602.050.121.VH.R
	5	12	45	2	6	6602.050.120.HW.R
	6	14	49	2	6	6602.060.140.HW.R
	6	20	50	2	6	6602.060.200.HW.R
	8	20	50	2	6	6602.080.200.HW.R
	8	30	57	2	6	6602.080.300.HW.R
	10	20	50	2	6	6602.100.200.HW.R
	10	30	57	2	6	6602.100.300.HW.R
	12	20	45	2	6	6602.120.200.HW.R
	12	30	57	2	6	6602.120.300.HW.R
	14	20	50	2	6	6602.140.200.HW.R
	15	20	48	2	6	6602.150.200.HW.R
	16	20	50	2	6	6602.160.200.HW.R
	16	30	57	2	6	6602.160.300.HW.R
	18	20	45	2	6	6602.180.200.HW.R
	20	20	51	2	6	6602.200.200.HW.R
	20	25	53	2	6	6602.200.250.HW.R
	22	20	50	2	6	6602.220.200.HW.R

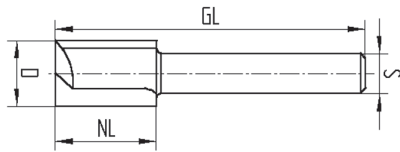

either one or two straight cutting edges • RH rotation •
standard length • parallel shank 8 mm

for use on portable and stationary routers with concentric
clamping chucks with manual feed (MAN)

for soft- and hardwood

HS	D	NL	GL	Z	S	Part number RH
	3	8	42	1	8	6804.030.080.HS.R
	4	10	48	2	8	6804.040.002.HS.R
	6	16	49	2	8	6804.060.160.HS.R
	8	20	51	2	8	6804.080.200.HS.R
	10	30	60	2	8	6804.100.300.HS.R
	14	20	48	2	8	6804.140.200.HS.R
	15	20	48	2	8	6804.150.200.HS.R
	18	20	50	2	8	6804.180.200.HS.R

for hardwood, wood composites and coated materials • no TC-fitted plunge tip

TC	D	NL	GL	Z	S	Part number RH
	3	6	45	2	8	6804.030.060.HW.R
	5	12	45	2	8	6804.050.120.HW.R
	6	14	44	2	8	6804.060.140.HW.R
	8	20	50	2	8	6804.080.200.HW.R
	10	30	57	2	8	6804.100.300.HW.R
	12	20	45	2	8	6804.120.200.HW.R
	15	20	48	2	8	6804.150.200.HW.R
	20	20	51	2	8	6804.200.200.HW.R
	22	20	50	2	8	6804.220.200.HW.R

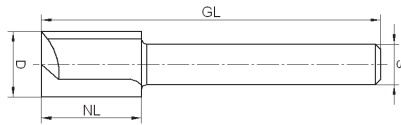

either one or two straight cutting edges • RH rotation •
long version • parallel shank 8 mm

for use on portable and stationary routers with concentric
clamping chucks with manual feed (MAN)

for soft- and hardwood

HS	D	NL	GL	Z	S	Part number RH
	2,5	6	55	1	8	6809.025.060.HS.R
	3	8	55	1	8	6809.030.080.HS.R
	3,5	8	55	1	8	6809.035.080.HS.R
	4	10	55	1	8	6809.040.100.HS.R
	4	12	70	1	8	6809.040.120.HS.R
	4,5	15	55	1	8	6809.045.150.HS.R
	5	17	55	2	8	6809.050.170.HS.R
	7	23	55	2	8	6809.070.230.HS.R
	8	23	55	2	8	6809.080.230.HS.R
	9	23	55	2	8	6809.090.230.HS.R
	11	20	60	2	8	6809.110.200.HS.R
	12	20	60	2	8	6809.120.200.HS.R
	13	20	60	2	8	6809.130.200.HS.R
	14	20	60	2	8	6809.140.200.HS.R
	15	20	60	2	8	6809.150.200.HS.R
	18	20	70	2	8	6809.180.200.HS.R
	22	10	70	2	8	6809.220.100.HS.R
	24	10	60	2	8	6809.240.100.HS.R
	25	10	70	2	8	6809.250.050.HS.R
	30	10	70	2	8	6809.300.050.HS.R

for hardwood, wood composites and coated materials • with TC-fitted plunge tip

TC	D	NL	GL	Z	S	Part number RH
	2	4	55	1	8	6809.020.040.HW.R
	3	6	55	2	8	6809.030.060.HW.R
	4	10	55	2	8	6809.040.100.HW.R
	5	12	55	2	8	6809.050.120.HW.R
	6	14	55	2	8	6809.060.140.HW.R
	7	17	55	2	8	6809.070.170.HW.R
	8	20	55	2	8	6809.080.200.HW.R
	8	30	90	2	8	6809.080.300.HW.R
	10	20	60	2	8	6809.100.200.HW.R
	10	30	90	2	8	6809.100.300.HW.R
	11	20	60	2	8	6809.110.200.HW.R
	12	20	60	2	8	6809.120.200.HW.R
	14	20	60	2	8	6809.140.200.HW.R
	14	30	90	2	8	6809.140.300.HW.R
	15	20	60	2	8	6809.150.200.HW.R
	18	20	70	2	8	6809.180.200.HW.R
	18	30	65	2	8	6809.180.300.HW.R
	22	20	70	2	8	6809.220.160.HW.R
	24	16	70	2	8	6809.240.160.HW.R
	25	16	70	2	8	6809.250.160.HW.R
	26	16	70	2	8	6809.260.160.HW.R
	28	16	70	2	8	6809.280.160.HW.R



two straight cutting edges • RH rotation •
parallel shank 10 mm

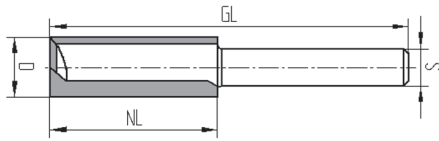

for use on portable and stationary routers
with manual feed (MAN)

for plastic, softwood and hardwood

HS	D	NL	GL	Z	S	Part number RH
	5	15	60	2	10	6105.050.000.HS.R
	6	15	60	2	10	6105.060.000.HS.R
	8	30	70	2	10	6105.080.000.HS.R
	13	40	75	2	10	6105.130.000.HS.R
	14	60	90	2	10	6105.140.600.HS.R
	18	15	57	2	10	6105.180.150.HS.R
	19	40	75	2	10	6105.190.000.HS.R
	20	40	75	2	10	6105.200.000.HS.R
	24	15	57	2	10	6105.240.150.HS.R

for hardwood, wood composites and coated materials • with TC-fitted plunge tip

TC	D	NL	GL	Z	S	Part number RH
	4	10	49	2	10	6105.040.000.HW.R
	8	20	60	2	10	6105.080.000.HW.R
	16	15	57	2	10	6105.160.150.HW.R
	20	25	70	2	10	6105.200.000.HW.R
	22	15	57	2	10	6105.220.150.HW.R
	22	25	70	2	10	6105.220.000.HW.R
	25	25	70	2	10	6105.250.000.HW.R

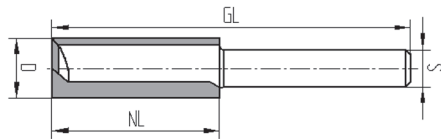

two straight cutting edges • RH rotation •
parallel shank 10 mm

for use on portable and stationary routers
with manual feed (MAN)

for plastic, softwood and hardwood

HS	D	NL	GL	Z	S	Part number RH
	15	42	87	2	10	6106.150.000.HS.R

for hardwood, wood composites and coated materials • with TC-fitted plunge tip

TC	D	NL	GL	Z	S	Part number RH
	10	35	87	2	10	6106.100.000.HW.R
	12	35	87	2	10	6106.120.000.HW.R
	14	35	87	2	10	6106.140.000.HW.R

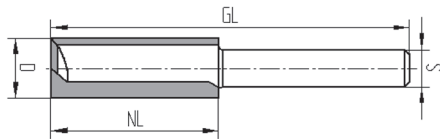

two straight cutting edges • RH or LH rotation •
parallel shank 10 mm

for use on portable and stationary routers
with manual feed (MAN)

for plastic, softwood and hardwood

HS	D	NL	GL	Z	S	Part number	Part number
						LH	RH
	10	40	97	2	10	6107.100.000.HS.L	-
	10	50	100	2	10	-	6107.1050.0010.HS.R
	20	48	97	2	10	-	6107.200.000.HS.R

for hardwood, wood composites and coated materials • with TC-fitted plunge tip

TC	D	NL	GL	Z	S	Part number	Part number
						LH	RH
	11	40	97	2	10	-	6107.110.000.HW.R
	17	45	97	2	10	-	6107.170.000.HW.R
	18	45	97	2	10	-	6107.180.000.HW.R



two straight cutting edges • RH rotation •
parallel shank 12 mm

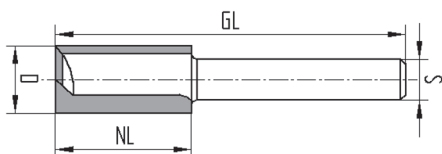

for use on portable and stationary routers with concentric
clamping chucks etc. with manual feed (MAN)

for soft- and hardwood

HS	D	NL	GL	Z	S	Part number RH
	12	35	90	2	12	6202.120.000.HS.R
	14	35	90	2	12	6202.140.000.HS.R
	14	50	110	2	12	6202.140.500.HS.R
	16	35	75	2	12	6202.160.350.HS.R
	16	35	90	2	12	6202.160.000.HS.R
	18	35	90	2	12	6202.180.000.HS.R
	20	35	90	2	12	6202.200.000.HS.R

for hardwood, wood composites and coated materials • with TC-fitted plunge tip

TC	D	NL	GL	Z	S	Part number RH
	10	35	90	2	12	6202.100.000.HW.R
	12	35	90	2	12	6202.120.350.HW.R
	14	35	90	2	12	6202.140.000.HW.R
	16	35	90	2	12	6202.160.000.HW.R
	16	60	110	2	12	6202.160.600.HW.R
	18	35	90	2	12	6202.180.000.HW.R
	18	60	110	2	12	6202.180.600.HW.R
	20	35	90	2	12	6202.200.000.HW.R
	22	60	110	2	12	6202.220.600.HW.R
	24	35	90	2	12	6202.240.000.HW.R



one straight cutting edge • RH rotation •
stepped parallel shank

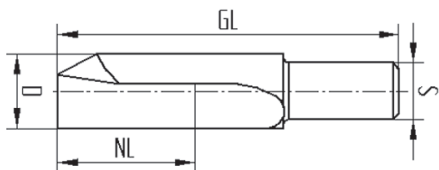

for grooving, jointing and contour cutting in softwood and
hardwood on stationary routers in excentric clamping chucks
with manual feed (MAN) or mechanical feed (MEC)

short design

620	D	NL	GL	S	Part number RH
	6,5	16	50	9,5	620.065.000.HS.R
	7	16	50	9,5	620.070.000.HS.R
	9	20	55	9,5	620.090.000.HS.R
	11	23	60	9,5	620.110.000.HS.R
	17	35	65	12	620.170.000.HS.R
	18	38	70	12	620.180.000.HS.R
	19	38	70	12	620.190.000.HS.R

long design

625	D	NL	GL	S	Part number RH
	18	60	90	12	625.180.000.HS.R
	20	65	95	12	625.200.000.HS.R

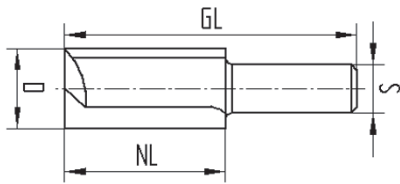
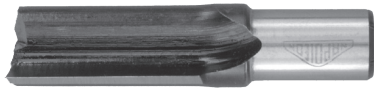

two straight cutting edges • RH rotation •
short design • stepped parallel shank

for grooving, jointing and contour cutting
on stationary routers in concentric clamping chucks
with manual feed (MAN) or mechanical feed (MEC)

for soft- and hardwood

630	D	NL	GL	S	Part number RH
HS	8	25	55	9,5	630.080.000.HS.R
	16	35	65	12	630.160.000.HS.R
	18	38	70	12	630.180.000.HS.R

for hardwood, wood composites and coated materials

631	D	NL	GL	S	Part number RH
TC	18	35	69	12	631.180.000.HW.R



two straight cutting edges • RH rotation •
short design • shank internal thread M10

for use on portable routers etc. with manual feed (MAN)

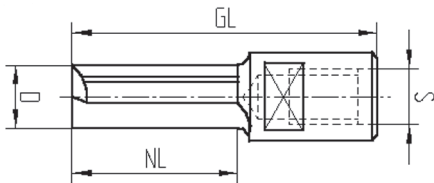

for soft- and hardwood

HS	D	NL	GL	Z	S	Part number RH
	4	12	55	2	IG M10	640-6.040.000.HS.R
	5	16	55	2	IG M10	640-6.050.000.HS.R
	6	18	55	2	IG M10	640-6.060.000.HS.R
	7	18	55	2	IG M10	640-6.070.000.HS.R
	8	20	55	2	IG M10	640-6.080.000.HS.R
	9	20	55	2	IG M10	640-6.090.000.HS.R
	11	20	55	2	IG M10	640-6.110.000.HS.R
	12	20	55	2	IG M10	640-6.120.000.HS.R
	13	22	55	2	IG M10	640-6.130.000.HS.R
	14	22	55	2	IG M10	640-6.140.000.HS.R
	15	25	55	2	IG M10	640-6.150.000.HS.R
	18	27	57	2	IG M10	640-6.180.000.HS.R
	19	27	57	2	IG M10	640-6.190.000.HS.R
	20	27	57	2	IG M10	640-6.200.000.HS.R
	22	27	57	2	IG M10	640-6.220.000.HS.R

for hardwood, wood composites and coated materials • with TC-fitted plunge tip

TC	D	NL	GL	Z	S	Part number RH
	6	14	55	2	IG M10	640-6.060.000.HW.R
	8	20	55	2	IG M10	640-6.080.000.HW.R
	10	25	55	2	IG M10	640-6.100.000.HW.R
	11	25	55	2	IG M10	640-6.110.000.HW.R
	12	25	55	2	IG M10	640-6.120.000.HW.R
	13	25	55	2	IG M10	640-6.130.000.HW.R
	14	25	55	2	IG M10	640-6.140.000.HW.R
	15	25	55	2	IG M10	640-6.150.000.HW.R
	16	25	55	2	IG M10	640-6.160.000.HW.R
	17	25	55	2	IG M10	640-6.170.000.HW.R
	18	25	57	2	IG M10	640-6.180.000.HW.R
	19	25	57	2	IG M10	640-6.190.000.HW.R
	20	25	57	2	IG M10	640-6.200.000.HW.R
	24	25	57	2	IG M10	640-6.240.000.HW.R
	25	25	57	2	IG M10	640-6.250.000.HW.R

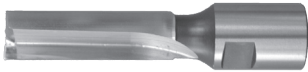

two straight cutting edges • RH rotation •
long design • shank internal thread M10

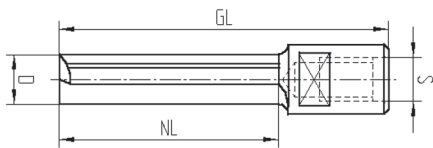

for use on portable routers etc. with manual feed (MAN)

for soft- and hardwood

HS	D	NL	GL	Z	S	Part number RH
	7	35	67	2	IG M10	641-6.070.000.HS.R
	9	35	67	2	IG M10	641-6.090.000.HS.R
	10	35	70	2	IG M10	641-6.100.000.HS.R
	11	40	70	2	IG M10	641-6.110.000.HS.R
	12	40	72	2	IG M10	641-6.120.000.HS.R
	13	40	70	2	IG M10	641-6.130.000.HS.R
	14	40	72	2	IG M10	641-6.140.000.HS.R
	15	45	75	2	IG M10	641-6.150.000.HS.R
	18	45	75	2	IG M10	641-6.180.000.HS.R
	24	45	75	2	IG M10	641-6.240.000.HS.R

for hardwood, wood composites and coated materials • with TC-fitted plunge tip

TC	D	NL	GL	Z	S	Part number RH
	12	35	67	2	IG M10	641-6.120.000.HW.R
	14	45	75	2	IG M10	641-6.140.450.HW.R
	15	45	75	2	IG M10	641-6.150.000.HW.R
	18	45	75	2	IG M10	641-6.180.000.HW.R
	20	45	75	2	IG M10	641-6.200.000.HW.R
	22	45	75	2	IG M10	641-6.220.000.HW.R
	24	45	75	2	IG M10	641-6.240.000.HW.R



two straight cutting edges • RH rotation •
shank internal thread M10

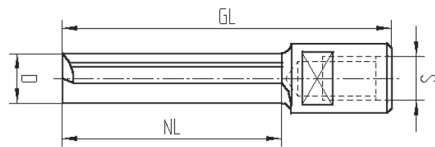

for use on portable routers etc. with manual feed (MAN)
for stair strings in softwood and hardwood

HS	D	NL	GL	Z	S	Part number RH
	9	60	94	2	IG M10	651-6.090.000.HS.R

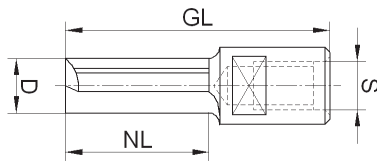

two straight cutting edges • RH rotation •
shank internal thread M12x1

for use on portable routers etc. with manual feed (MAN)

for soft- and hardwood

HS	D	NL	GL	Z	S	Part number RH
	8	23	60	2	IG M12x1	643-9.080.000.HS.R
	9	23	60	2	IG M12x1	643-9.090.000.HS.R
	10	23	60	2	IG M12x1	643-9.100.000.HS.R
	11	23	60	2	IG M12x1	643-9.110.000.HS.R
	12	23	60	2	IG M12x1	643-9.120.000.HS.R
	13	23	60	2	IG M12x1	643-9.130.000.HS.R
	14	23	60	2	IG M12x1	643-9.140.000.HS.R
	15	25	60	2	IG M12x1	643-9.150.000.HS.R
	16	25	60	2	IG M12x1	643-9.160.000.HS.R
	20	25	60	2	IG M12x1	643-9.200.000.HS.R
	22	25	60	2	IG M12x1	643-9.220.000.HS.R
	34	25	60	2	IG M12x1	643-9.340.000.HS.R
	35	25	60	2	IG M12x1	643-9.350.000.HS.R

for hardwood, wood composites and coated materials • with TC-fitted plunge tip

TC	D	NL	GL	Z	S	Part number RH
	8	20	60	2	IG M12x1	643-9.080.000.HW.R
	9	23	60	2	IG M12x1	643-9.090.000.HW.R
	10	25	60	2	IG M12x1	643-9.100.000.HW.R
	11	23	60	2	IG M12x1	643-9.110.000.HW.R
	12	25	60	2	IG M12x1	643-9.120.000.HW.R
	13	25	60	2	IG M12x1	643-9.130.000.HW.R
	14	25	60	2	IG M12x1	643-9.140.000.HW.R
	15	25	60	2	IG M12x1	643-9.150.000.HW.R
	16	25	60	2	IG M12x1	643-9.160.000.HW.R
	17	25	60	2	IG M12x1	643-9.170.000.HW.R
	18	25	60	2	IG M12x1	643-9.180.000.HW.R
	19	25	60	2	IG M12x1	643-9.190.000.HW.R
	20	25	60	2	IG M12x1	643-9.200.000.HW.R
	22	25	60	2	IG M12x1	643-9.220.000.HW.R
	25	25	60	2	IG M12x1	643-9.250.000.HW.R
	30	25	60	2	IG M12x1	643-9.300.000.HW.R

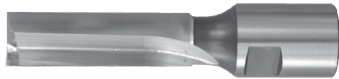

two straight cutting edges • RH rotation •
shank internal thread M12x1

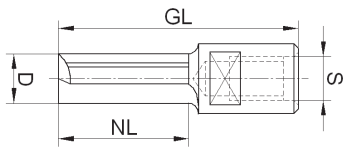

for use on portable routers etc. with manual feed (MAN)

for soft- and hardwood

HS	D	NL	GL	Z	S	Part number RH
	9	35	67	2	IG M12x1	644-9.090.000.HS.R
	10	35	67	2	IG M12x1	644-9.100.000.HS.R
	12	35	67	2	IG M12x1	644-9.120.000.HS.R

for hardwood, wood composites and coated materials • with TC-fitted plunge tip

TC	D	NL	GL	Z	S	Part number RH
	12	35	67	2	IG M12x1	644-9.120.000.HW.R
	14	35	67	2	IG M12x1	644-9.140.000.HW.R
	16	35	67	2	IG M12x1	644-9.160.000.HW.R
	18	35	67	2	IG M12x1	644-9.180.000.HW.R
	20	35	67	2	IG M12x1	644-9.200.000.HW.R
	25	35	67	2	IG M12x1	644-9.250.000.HW.R

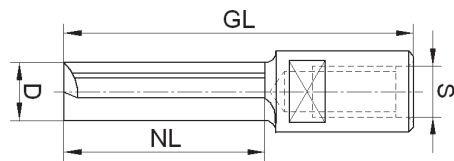

two straight cutting edges • RH rotation •
shank internal thread M12x1

for use on portable routers etc. with manual feed (MAN)

for soft- and hardwood

HS	D	NL	GL	Z	S	Part number RH
	12	45	80	2	IG M12x1	642-9.120.000.HS.R
	18	45	80	2	IG M12x1	642-9.180.000.HS.R
	20	45	80	2	IG M12x1	642-9.200.000.HS.R

for hardwood, wood composites and coated materials • with TC-fitted plunge tip

TC	D	NL	GL	Z	S	Part number RH
	12	45	80	2	IG M12x1	642-9.120.450.HW.R
	14	45	80	2	IG M12x1	642-9.140.000.HW.R
	15	45	80	2	IG M12x1	642-9.150.000.HW.R
	16	45	80	2	IG M12x1	642-9.160.000.HW.R
	18	45	80	2	IG M12x1	642-9.180.000.HW.R
	20	45	80	2	IG M12x1	642-9.200.000.HW.R



two straight cutting edges • RH rotation •
shank internal thread M12x1

for use on portable routers etc. with manual feed (MAN)

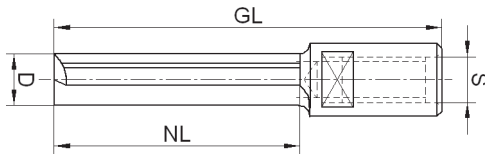

for soft- and hardwood

HS	D	NL	GL	Z	S	Part number RH
	18	60	92	2	IG M12x1	645-9.180.000.HS.R
	20	60	92	2	IG M12x1	645-9.200.000.HS.R
	24	60	92	2	IG M12x1	645-9.240.000.HS.R

for hardwood, wood composites and coated materials • with TC-fitted plunge tip

TC	D	NL	GL	Z	S	Part number RH
	18	60	92	2	IG M12x1	645-9.180.000.HW.R
	20	60	92	2	IG M12x1	645-9.200.000.HW.R

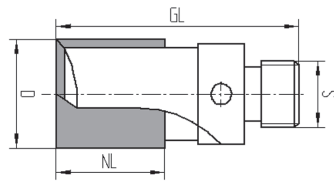
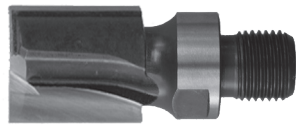
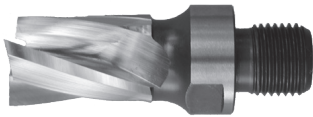

either two or three cutting edges • helical or straight edge •
RH rotation • shank external thread M16x1,5

for use on portable routers etc. with manual feed (MAN)

for soft- and hardwood • helical edge

HS	<i>D</i>	<i>NL</i>	<i>GL</i>	<i>Z</i>	<i>S</i>	<i>Part number RH</i>
	20	30	64	3	AG M16x1,5	650-16.200.000.HS.R

for hardwood, wood composites and coated materials • straight edge • with TC-fitted plunge tip

TC	<i>D</i>	<i>NL</i>	<i>GL</i>	<i>Z</i>	<i>S</i>	<i>Part number RH</i>
	25	25	61	2	AG M16x1,5	650-16.250.002.HW.R
	25	25	61	3	AG M16x1,5	650-16.250.003.HW.R
	35	25	61	2	AG M16x1,5	650-16.350.002.HW.R

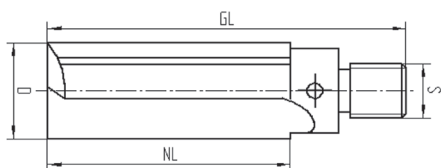

two straight cutting edges • RH rotation •
shank external thread M16x1,5

for use on portable routers etc. with manual feed (MAN)
for stair strings in softwood and hardwood

HS	D	NL	GL	Z	S	Part number RH
	12	60	99	2	AG M16x1,5	651-16.120.000.HS.R
	16	60	99	2	AG M16x1,5	651-16.160.000.HS.R

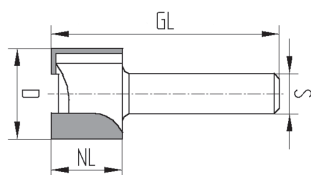

two cutting edges • RH rotation • parallel shank 6 mm

for working hardwood, wood composites and coated materials on portable routers etc. with manual feed (MAN)

TC	D	NL	GL	S	Part number RH
	18	12	37	6	6620.180.120.HW.R
	20	16	44	6	6620.200.160.HW.R

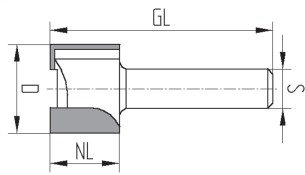
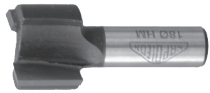

two cutting edges • RH rotation • parallel shank 8 mm

for working hardwood, wood composites and coated materials on portable routers etc. with manual feed (MAN)

TC	D	NL	GL	Z	S	Part number RH
	18	12	37	2	8	6820.180.120.HW.R

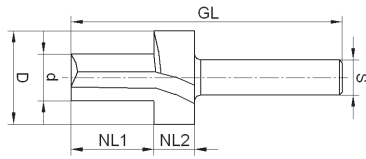

two cutting edges • RH rotation • two-stage •
parallel shank 8 mm

for cutting stepped grooves for closure fittings etc.
in softwood and hardwood on portable routers etc.
with manual feed (MAN)

HS	d	NL1	D	NL2	GL	Z	S	Part number RH
	11	10	16	10	50	2	8	6860.110.161.HS.R

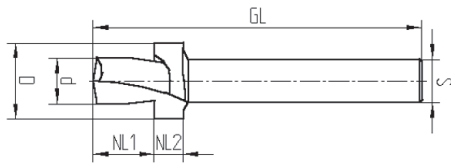

two helical cutting edges • two-stage • RH or LH rotation •
special design • parallel shank

for cutting casement bolts in aluminium and
UPVC profiles etc. on copying machines e. g. Rotox

HS	d	NL1	D	NL2	GL	Z	S	Part number	Part number
								LH	RH
	6,5	5,6	18	4	117	2	8	-	7860.065.180.HS.R
	8	17,5	16	13	70,5	2	10	-	7160.080.160.HS.R
	10	15	12,5	5	75	2	10	-	7160.100.125.HS.R
	10,1	7	17,1	7	75	2	10	7160.101.171.HS.L	7160.101.171.HS.R
	10,1	12	17,1	7	75	2	10	7160.101.127.HS.L	7160.101.127.HS.R
	10,3	22	13,1	7	70	2	10	-	7160.103.131.HS.R
	10,5	14	15	7	77	2	10	-	7160.105.157.HS.R
	10,5	7	17,5	7	75	2	10	7160.105.775.HS.L	7160.105.775.HS.R
	10,5	7	17,5	7	95	2	10	-	7160.105.795.HS.R
	10,5	12	17,5	7	75	2	10	7160.105.175.HS.L	7160.105.175.HS.R
	10,5	12	17,5	7	95	2	10	7160.105.950.HS.L	7160.105.950.HS.R
	12	7	21	7	75	2	10	-	7160.120.210.HS.R
	12,1	7	19,1	7	70	2	10	7160.121.707.HS.L	7160.121.707.HS.R
	12,1	12	19,1	7	75	2	10	-	7160.121.750.HS.R
	12,1	12	19,1	7	95	2	10	7160.121.191.HS.L	-
	12,5	22	19,5	7	95	2	10	-	7160.125.195.HS.R
	12,5	35	19,5	15	115	2	12	-	7260.125.195.HS.R
	14	7	22	10	75	2	10	7160.140.220.HS.L	-

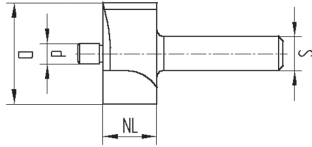
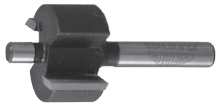

two cutting edges • RH rotation • with guide pin •
parallel shank 8 mm

for working softwood and hardwood on portable routers etc.
with manual feed (MAN)

HS	D	NL	d	Z	S	Part number RH
	23,8	13	4,8	2	8	6852.238.000.HS.R

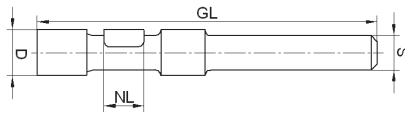

one cutting edge • RH rotation • with guide pin •
parallel shank 6 mm

for milling apertures, contour cutting, etc.
in hardwood, wood composites and coated materials
on portable routers etc. with manual feed (MAN)

TC	D	NL	GL	S	Part number RH
	8	8	48	6	6614.080.000.HW.R



one cutting edge • RH rotation • with guide pin •
parallel shank 8 mm

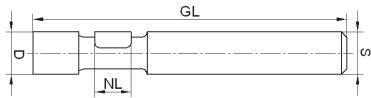

for apertures, contour cutting, etc. in hardwood,
wood composites and coated materials on portable
routers etc. with manual feed (MAN)

TC

D

8

NL

8

GL

48

Z

1

S

8

Part number
RH

6814.080.000.HW.R

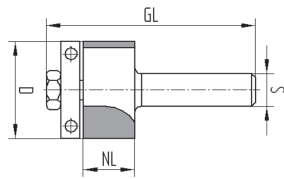

two cutting edges • RH rotation • with ball bearing guide • parallel shank 6 mm

for working hardwood, wood composites and coated materials on portable routers etc. with manual feed (MAN)

TC	D	NL	GL	S	Part number RH
	12,7	25	63	6	6670.127.250.HW.R
	13	6,35	50	6	6670.130.063.HW.R
	19	12	50	6	6670.190.120.HW.R
	22	16	55	6	6670.220.160.HW.R
	22	20	60	6	6670.220.200.HW.R

spare parts

Denotation	D	d	PU	Part number spare parts
ball bearing	12,7	4,8	3	100.127.048.SM.0
ball bearing	13	4	3	100.130.040.SM.0
ball bearing	19	6	3	100.190.060.SM.0
ball bearing	22	6,35 with AR	3	100.220.063.SM.A

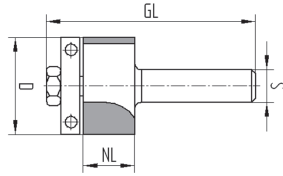
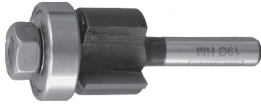

two cutting edges • RH rotation • with ball bearing guide •
parallel shank 8 mm

for working hardwood, wood composites and coated
materials on portable routers etc. with manual feed (MAN)

TC						
	D	NL	GL	Z	S	Part number RH
	12,7	25	63	2	8	6870.127.250.HW.R
	13	6,35	52	2	8	6870.130.063.HW.R
	22	20	60	2	8	6870.220.200.HW.R

spare parts

	Denotation	D	d	PU	Part number spare parts
	ball bearing	12,7	4,8	3	100.127.048.SM.0
	ball bearing	13	4	3	100.130.040.SM.0
	ball bearing	22	6,35 with AR	3	100.220.063.SM.A

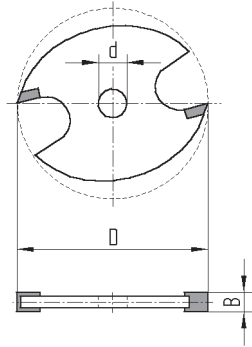

two TC-fitted cutting edges • RH rotation • bore 6 mm

for grooving and slotting of hardwood, wood composites and coated materials on spindles and arbors etc. with manual feed (MAN)

version with bore 8 mm available without extra-charge

diameter 40 mm

6640	B	D	d	Z	Part number RH
	1,5	40	6	2	6640.015.000.HW.R
	2	40	6	2	6640.020.000.HW.R
	2,2	40	6	2	6640.022.000.HW.R
	2,5	40	6	2	6640.025.000.HW.R
	2,8	40	6	2	6640.028.000.HW.R
	3,5	40	6	2	6640.035.000.HW.R
	4	40	6	2	6640.040.000.HW.R
	5	40	6	2	6640.050.000.HW.R
	6	40	6	2	6640.060.000.HW.R

diameter 45 mm

6645	B	D	d	Z	Part number RH
	1,5	45	6	2	6645.015.000.HW.R
	1,8	45	6	2	6645.018.000.HW.R
	2	45	6	2	6645.020.000.HW.R
	2,2	45	6	2	6645.022.000.HW.R
	2,5	45	6	2	6645.025.000.HW.R
	2,8	45	6	2	6645.028.000.HW.R
	3	45	6	2	6645.030.000.HW.R
	3,5	45	6	2	6645.035.000.HW.R
	4	45	6	2	6645.040.000.HW.R
	5	45	6	2	6645.050.000.HW.R
	6	45	6	2	6645.060.000.HW.R

ARBOR

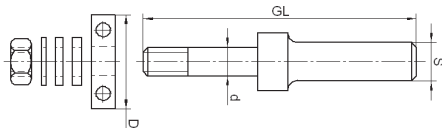

to take grooving saws with bore diameter 6 or 8 mm in RH rotation on portable routers etc.

for bore diameter 6 mm

	D	d	GL	S	Part number RH
	12	6	45	6	6641.120.060.SM.R
	12	6	50	8	6841.120.060.SM.R

for bore diameter 6 mm • with ball bearing

	D	d	GL	S	Part number RH
	19	6	52	6	6671.190.060.SM.R
	19	6	52	8	6871.190.060.SM.R
	19	6	54	IG M10	6971-6.000.000.SM.R

for bore diameter 8 mm

	D	d	GL	S	Part number RH
	16	8	54	8	6841.160.080.SM.R

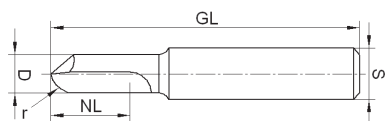

one cutting edge • RH rotation • parallel shank 8 mm

for decorative grooving, lettering and engraving, etc.
in softwood and hardwood on portable routers etc.
with manual feed (MAN)

HS	D	r	NL	GL	Z	S	Part number RH
	4,8	2,4	12	44	1	8	6817.048.024.HS.R

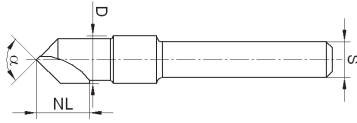

one cutting edge • RH rotation • parallel shank 6 mm

for milling V-grooves, decorative grooves, lettering and bevelling in hardwood, wood composites and coated materials on portable routers etc. with manual feed (MAN)

TC	D	α	NL	Z	S	Part number RH
	8	90	9	1	6	6611.080.900.HW.R

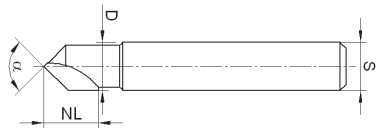
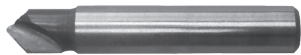

one cutting edge • RH rotation • parallel shank 8 mm

for V-grooves, decorative grooves, lettering and bevelling of hardwood, wood composites and coated materials on portable routers etc. with manual feed (MAN)

TC	D	α	NL	Z	S	Part number RH
	8	90	9	1	8	6811.080.900.HW.R

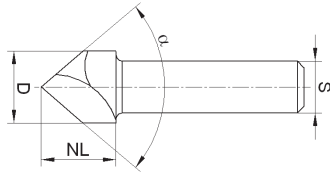

two cutting edges • RH rotation • parallel shank 6 mm

for milling V-grooves, decorative grooves, lettering or bevelling
on portable routers etc. with manual feed (MAN)

for soft- and hardwood

HS	D	α	NL	Z	S	Part number RH
	11	60	14	2	6	6610.110.600.HS.R
	12,5	90	18	2	6	6610.125.900.HS.R
	14	90	18	2	6	6610.140.900.HS.R

for hardwood, wood composites and coated materials

TC	D	α	NL	Z	S	Part number RH
	14	90	13	2	6	6610.140.900.HW.R

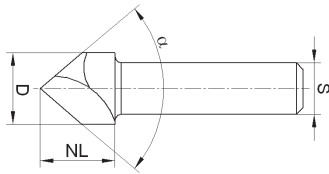
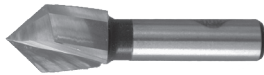

two cutting edges • RH rotation • parallel shank 8 mm

for V-grooves, decorative grooves, lettering or bevelling
on portable routers etc. with manual feed (MAN)

for soft- and hardwood

HS	D	α	NL	Z	S	Part number RH
	11	60	14	2	8	6810.110.600.HS.R
14	90	18	2	8	6810.140.900.HS.R	

for hardwood, wood composites and coated materials

TC	D	α	NL	Z	S	Part number RH
	14	90	13	2	8	6810.140.900.HW.R

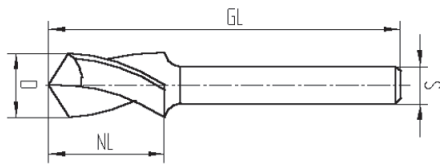

two helical cutting edges • V-point • RH rotation •
parallel shank 8 mm

for working UPVC profiles on copying machines
e. g. Rapid • Striffler • Wegoma

HS	D	NL	GL	Z	S	Part number RH
	12	20	80	2	8	7806.1220.X080.HS.R
	14	20	110	2	8	7806.1420.X011.HS.R

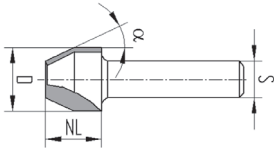

two cutting edges • RH rotation • parallel shank 6 mm

for working hardwood, wood composites and coated materials on portable routers etc. with manual feed (MAN)

TC	D	α	NL	S	Part number RH
	12	22	12	6	6621.120.220.HW.R
12	45	12	6	6621.120.450.HW.R	

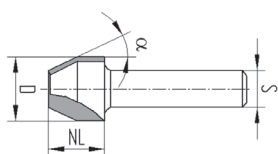

two cutting edges • RH rotation • parallel shank 8 mm

for working hardwood, wood composites and coated materials on portable routers etc. with manual feed (MAN)

TC	D	α	NL	Z	S	Part number RH
	12	22	12	2	8	6821.120.220.HW.R

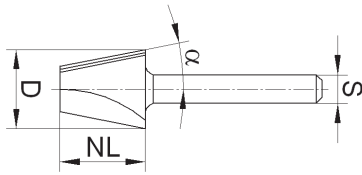
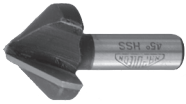

two cutting edges • RH rotation • parallel shank 6 mm

for working softwood and hardwood on portable routers etc. with manual feed (MAN)

HS	D	α	NL	S	Part number RH
	22,8	45	14	6	6622.228.450.HS.R

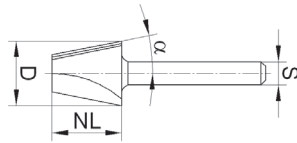
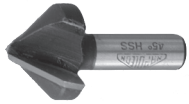

two cutting edges • RH rotation • parallel shank 8 mm

for working softwood and hardwood on portable routers etc. with manual feed (MAN)

HS	D	α	NL	Z	S	Part number RH
	22,8	45	14	2	8	6822.228.450.HS.R

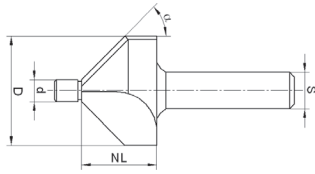

two cutting edges • RH rotation • with guide pin •
parallel shank 6 mm

for use on portable routers etc. with manual feed (MAN)

for soft- and hardwood

HS	D	α	NL	d	s	Part number RH
	22,8	45	16,5	4,8	6	6650.228.000.HS.R

for hardwood, wood composites and coated materials

TC	D	α	NL	d	s	Part number RH
	12,5	45	11,5	4,8	6	6650.125.000.HW.R

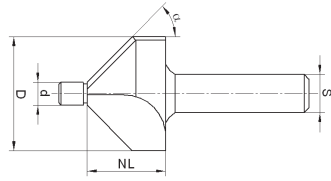

two cutting edges • RH rotation • with guide pin •
parallel shank 8 mm

for working hardwood, wood composites and coated
materials on portable routers etc. with manual feed (MAN)

TC	D	α	NL	d	Z	S	Part number RH
	12,5	45	11,5	4,8	2	8	6850.125.000.HW.R

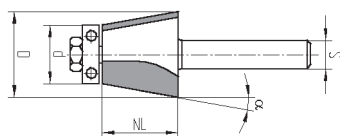
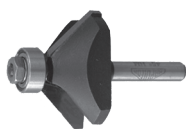

two cutting edges • RH rotation • with ball bearing guide •
parallel shank 6 mm

for working hardwood, wood composites and coated
materials on portable routers etc. with manual feed (MAN)

TC	D	a	NL	d	S	Part number RH
	35,2	45	15	12,7	6	6672.352.450.HW.R

spare parts

Denotation	D	d	PU	Part number spare parts
ball bearing	12,7	4,8	3	100.127.048.SM.0

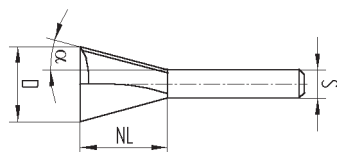

two cutting edges • RH rotation • parallel shank 6 mm

for working softwood and hardwood on portable routers etc. with manual feed (MAN)

HS	D	α	NL	S	Part number RH
	10	15	7	6	6630.100.000.HS.R
	12	15	8	6	6630.120.000.HS.R
	14	15	10	6	6630.140.000.HS.R
	16	15	13	6	6630.160.000.HS.R

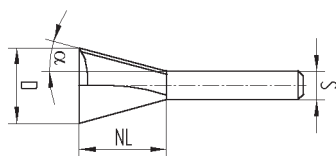

two cutting edges • RH rotation • parallel shank 8 mm

for working softwood and hardwood on portable routers etc. with manual feed (MAN)

HS	D	α	NL	Z	S	Part number RH
	10	15	7	2	8	6830.100.000.HS.R
	12	15	8	2	8	6830.120.000.HS.R

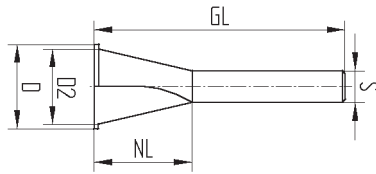

two cutting edges • with scorer • RH rotation •
parallel shank 6 mm

for working softwood and hardwood on portable
routers etc. with manual feed (MAN)

HS	D	D2	NL	GL	S	Part number RH
	14,3	12,7	13,5	44	6	6632.143.000.HS.R

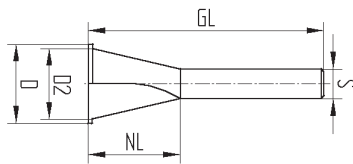

two cutting edges • with scorer • RH rotation •
parallel shank 8 mm

for use on portable routers etc. with manual feed (MAN)

for soft- and hardwood

HS	D	D2	NL	GL	Z	S	Part number RH
	14,3	12,7	13,5	44	2	8	6832.143.000.HS.R

for hardwood, wood composites and coated materials

TC	D	D2	NL	GL	Z	S	Part number RH
	14,3	12,7	13,5	46	2	8	6832.143.000.HW.R

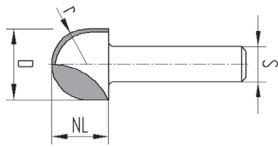

two cutting edges • RH rotation • parallel shank 6 mm

for use on portable routers etc. with manual feed (MAN)

for soft- and hardwood

HS	D	r	NL	S	Part number RH
	8	4	9	6	6618.080.040.HS.R
	12,7	6,35	9	6	6618.127.063.HS.R
	16	8	10	6	6618.160.080.HS.R
	20	10	15	6	6618.200.100.HS.R

for hardwood, wood composites and coated materials

TC	D	r	NL	S	Part number RH
	12,7	6,35	9	6	6618.127.063.HW.R

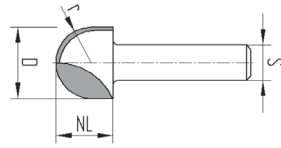

two cutting edges • RH rotation • parallel shank 8 mm

for use on portable routers etc. with manual feed (MAN)

for soft- and hardwood

HS	D	r	NL	Z	S	Part number RH
	8	4	9	2	8	6818.080.040.HS.R
	9,5	4,75	10	2	8	6818.095.047.HS.R
	12,7	6,35	9	2	8	6818.127.063.HS.R
	16	8	10	2	8	6818.160.080.HS.R
	20	10	15	2	8	6818.200.100.HS.R

for hardwood, wood composites and coated materials

TC	D	r	NL	Z	S	Part number RH
	12,7	6,35	9	2	8	6818.127.063.HW.R

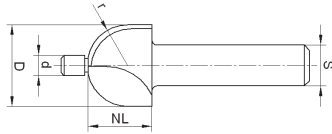

two cutting edges • RH rotation • with guide pin •
parallel shank 6 mm

for working softwood and hardwood on portable
routers etc. with manual feed (MAN)

HS	D	r	NL	d	S	Part number RH
	11	5,5	9	4,8	6	6658.110.055.HS.R
	13	6,5	9	4,8	6	6658.130.065.HS.R
	15	7,5	9	4,8	6	6658.150.075.HS.R
	17,6	6,35	13	4,8	6	6658.176.064.HS.R
	23,8	9,5	18	4,8	6	6658.238.095.HS.R

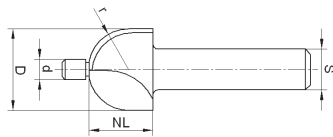

two cutting edges • RH rotation • with guide pin •
parallel shank 8 mm

for working softwood and hardwood on portable routers etc.
with manual feed (MAN)

HS	D	r	NL	d	Z	S	Part number RH
	17,6	6,35	13	4,8	2	8	6858.176.064.HS.R
23,8	9,5	18	4,8	2	8	6858.238.095.HS.R	

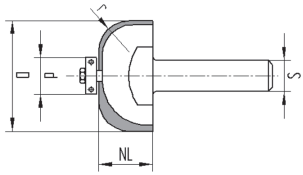
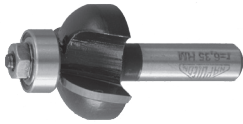

two cutting edges • RH rotation • with ball bearing guide •
parallel shank 8 mm

for working hardwood, wood composites and coated
materials on portable routers etc. with manual feed (MAN)

TC	D	r	NL	d	Z	S	Part number RH
	25,4	6,35	12,7	12,7	2	8	6877.254.064.HW.R

spare parts

Denotation	D	d	PU	Part number spare parts
ball bearing	12,7	4,8	3	100.127.048.SM.0

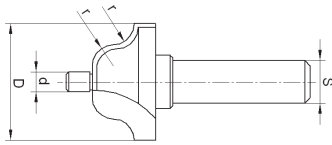

two cutting edges • RH rotation • with guide pin •
parallel shank 6 mm

for working softwood and hardwood on portable
routers etc. with manual feed (MAN)

HS	<i>D</i>	<i>r</i>	<i>d</i>	<i>S</i>	<i>Part number</i> <i>RH</i>
	23,8	4/4	4,8	6	6659.238.040.HS.R
30,2	6,35/6,35	4,8	6	6659.302.063.HS.R	

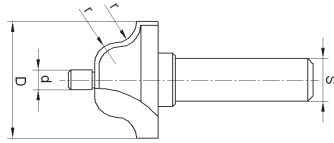

two cutting edges • RH rotation • with guide pin •
parallel shank 8 mm

for working softwood and hardwood on portable routers etc.
with manual feed (MAN)

HS	D	r	d	Z	S	Part number RH
	23,8	4/4	4,8	2	8	6859.238.040.HS.R
	30,2	6,35/6,35	4,8	2	8	6859.302.063.HS.R

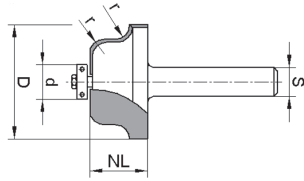

two cutting edges • RH rotation • with ball bearing guide • parallel shank 8 mm

for working hardwood, wood composites and coated materials on portable routers etc. with manual feed (MAN)

TC

<i>D</i>	<i>r</i>	<i>NL</i>	<i>d</i>	<i>Z</i>	<i>S</i>	<i>Part number RH</i>
31,7	4/4	13	12,7	2	8	6879.317.040.HW.R

spare parts

<i>Denotation</i>	<i>D</i>	<i>d</i>	<i>PU</i>	<i>Part number spare parts</i>
ball bearing	12,7	4,8	3	100.127.048.SM.0

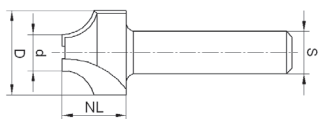

two cutting edges • RH rotation • parallel shank 6 mm

for working softwood and hardwood on portable routers etc. with manual feed (MAN)

HS	D	r	d	NL	S	Part number RH
	16	5	6	10	6	6625.160.050.HS.R

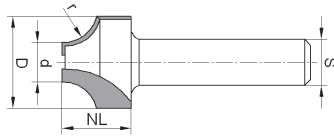

two cutting edges • RH rotation • parallel shank 8 mm

for use on portable routers etc. with manual feed (MAN)

for soft- and hardwood

HS	D	r	d	NL	Z	S	Part number RH
	16	5	6	10	2	8	6825.160.050.HS.R

for hardwood, wood composites and coated materials • no TC-fitted plunge tip

TC	D	r	d	NL	Z	S	Part number RH
	26	6,35	13	12	2	8	6825.260.063.HW.R

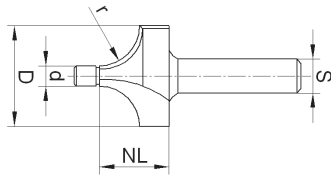

two cutting edges • RH rotation • with guide pin •
parallel shank 6 mm

for working softwood and hardwood on portable
routers etc. with manual feed (MAN)

HS	D	r	NL	d	S	Part number RH
	14,8	5	11	4,8	6	6654.148.050.HS.R
	17,5	6,35	13,4	4,8	6	6654.175.063.HS.R
	20,8	8	15	4,8	6	6654.208.080.HS.R
	23,8	9,5	16	4,8	6	6654.238.095.HS.R

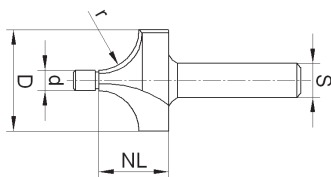

two cutting edges • RH rotation • with guide pin •
parallel shank 8 mm

for working softwood and hardwood on portable routers etc.
with manual feed (MAN)

HS	D	r	NL	d	Z	S	Part number RH
	17,5	6,35	13,4	4,8	2	8	6854.175.063.HS.R
	20,8	8	15	4,8	2	8	6854.208.080.HS.R
	23,8	9,5	16	4,8	2	8	6854.238.095.HS.R

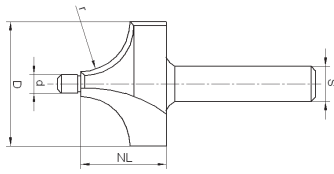

two cutting edges • RH rotation • with guide pin •
parallel shank 6 mm

for working softwood and hardwood on portable
routers etc. with manual feed (MAN)

HS	D	r	NL	d	S	Part number RH
	21,6	6,35	14	4,8	6	6656.216.064.HS.R
28,0	9,5	16	4,8	6	6656.280.095.HS.R	

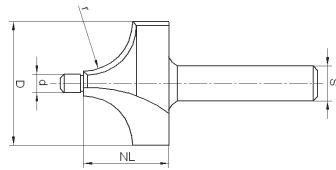
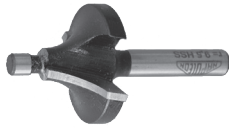

two cutting edges • RH rotation • with guide pin •
parallel shank 8 mm

for working softwood and hardwood on portable routers etc.
with manual feed (MAN)

HS	D	r	NL	d	Z	S	Part number RH
	21,6	6,35	14	4,8	2	8	6856.216.064.HS.R
28,0	9,5	16	4,8	2	8	6856.280.095.HS.R	

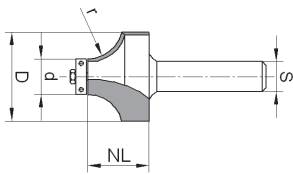
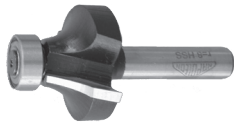

two cutting edges • RH rotation • with ball bearing guide •
parallel shank 6 mm

for working hardwood, wood composites and coated
materials on portable routers etc. with manual feed (MAN)

TC	D	r	NL	d	S	Part number RH
	16,7	2	8	12,7	6	6676.167.020.HW.R
	20,7	4	12	12,7	6	6676.207.040.HW.R
	25,5	6,35	12	12,7	6	6676.255.064.HW.R
	28,7	8	15	12,7	6	6676.287.080.HW.R
	38,1	12,7	19,7	12,7	6	6676.381.127.HW.R

spare parts

Denotation	D	d	PU	Part number spare parts
ball bearing	12,7	4,8	3	100.127.048.SM.0

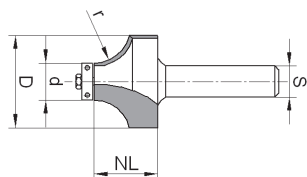

two cutting edges • RH rotation • with ball bearing guide •
parallel shank 8 mm

for use on portable routers etc. with manual feed (MAN)

for soft- and hardwood

HS	D	r	NL	d	Z	S	Part number RH
	28,7	8	15	12,7	2	8	6876.287.080.HS.R
	38,1	12,7	19,7	12,7	2	8	6876.381.127.HS.R

for hardwood, wood composites and coated materials

TC	D	r	NL	d	Z	S	Part number RH
	16,7	2	8	12,7	2	8	6876.167.020.HW.R
	18,7	3	8	12,7	2	8	6876.187.030.HW.R
	20,7	4	12	12,7	2	8	6876.207.040.HW.R
	22,7	5	12	12,7	2	8	6876.227.050.HW.R
	28,7	8	15	12,7	2	8	6876.287.080.HW.R
	31,7	9,5	16	12,7	2	8	6876.317.095.HW.R
	42,7	15	21	12,7	2	8	6876.427.150.HW.R

spare parts

Denotation	D	d	PU	Part number spare parts
ball bearing	12,7	4,8	3	100.127.048.SM.0

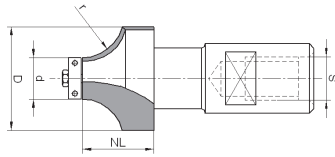
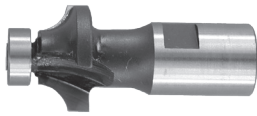

two cutting edges • RH rotation • with ball bearing guide •
shank internal thread M10

for working hardwood, wood composites and coated
materials on portable routers etc. with manual feed (MAN)

TC	D	r	NL	d	Z	S	Part number RH
	18,7	3	8	12,7	2	IG M10	6976-6.187.030.HW.R
	25,5	6,35	12	12,7	2	IG M10	6976-6.255.064.HW.R
	31,7	9,5	16	12,7	2	IG M10	6976-6.317.095.HW.R
	42,7	15	21	12,7	2	IG M10	6976-6.427.150.HW.R

spare parts

Denotation	D	d	PU	Part number spare parts
ball bearing	12,7	4,8	3	100.127.048.SM.0

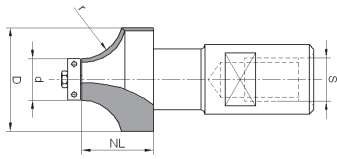
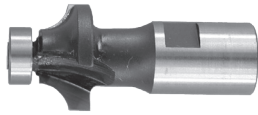

two cutting edges • RH rotation • with ball bearing guide •
shank internal thread M12x1

for working hardwood, wood composites and coated
materials on portable routers etc. with manual feed (MAN)

TC	D	r	NL	d	Z	S	Part number RH
	18,7	3	8	12,7	2	IG M12x1	6976-9.187.030.HW.R
	25,5	6,35	12	12,7	2	IG M12x1	6976-9.255.064.HW.R
	28,7	8	15	12,7	2	IG M12x1	6976-9.287.080.HW.R
	31,7	9,5	16	12,7	2	IG M12x1	6976-9.317.095.HW.R
	42,7	15	21	12,7	2	IG M12x1	6976-9.427.150.HW.R

spare parts

Denotation	D	d	PU	Part number spare parts
ball bearing	12,7	4,8	3	100.127.048.SM.0

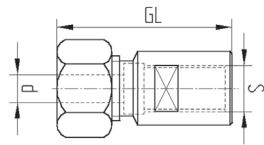

threepart • RH rotation

consisting of:
 holding fixture with shank internal thread M10
 collet
 nut

for e. g. Scheer

	<i>complete</i>	<i>d</i>	<i>GL</i>	<i>S</i>	<i>Part number RH</i>
	for shank 6	6	39	IG M10	315-6.060.000.SM.R

component parts

	<i>Denotation</i>	<i>d</i>	<i>Part number components</i>
	collet	6	315-0.000.060.SM.0

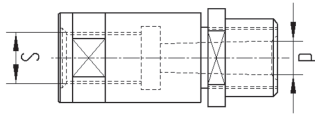
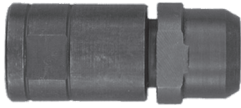

threepart • RH rotation

consisting of:
 holding fixture with shank internal thread M10
 collet
 nut

for e. g. Scheer

	<i>complete</i>	<i>d</i>	<i>S</i>	<i>Part number</i> <i>RH</i>
	for shank 6	6	IG M10	7315-6.060.000.SM.R

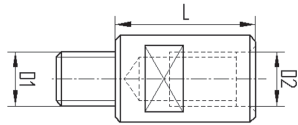

to extend dowel drills with threaded shank M10 •
RH rotation

for e. g. Ayen • Mayer • Scheer

	<i>D1</i>	<i>D2</i>	<i>L</i>	<i>Part number RH</i>
	AG M10	IG M10	18	318-6.180.000.SM.R
	AG M10	IG M10	25	318-6.250.000.SM.R
	AG M10	IG M10	35	318-6.350.000.SM.R



to extend dowel drills with threaded shank M12x1 •
RH rotation

for e. g. Elu

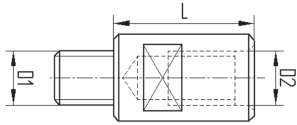

	<i>D1</i>	<i>D2</i>	<i>L</i>	<i>Part number RH</i>
	AG M12x1	IG M12x1	25	318-9.250.000.SM.R
	AG M12x1	IG M12x1	35	318-9.350.000.SM.R
	AG M12x1	IG M12x1	40	318-9.400.000.SM.R

RH rotation

for e. g. Elu (DeWalt) • Haffner • Holzma • Scheer

internal thread / external thread

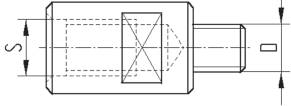

S	D	Part number RH
IG M10	AG M12x1	321.000.000.SM.R
IG M12x1	AG M10	320.000.000.SM.R

cylindrical / external thread

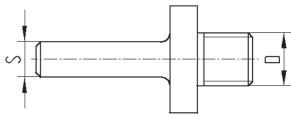

S	D	Part number RH
8x25 zyl.	AG M10	323.080.000.SM.R
10x30 zyl.	AG M12x1	322.100.000.SM.R
12x50 zyl.	AG M12x1	326.000.000.SM.R

cylindrical / internal thread

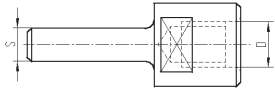

S	D	Part number RH
8x25 zyl.	IG M10	321.000.080.SM.R

1	General Terms and Conditions of Contract
1.1	The acceptance and performance of orders are subject to our Business Terms and Conditions set forth below. Deviations must be agreed upon in writing. Unless the wording of the offer indicates differently, our offers are non-binding and subject to change.
1.2	Our Business Terms and Conditions are deemed acknowledged when an order is issued or a delivery accepted. Similarly, they are deemed acknowledged if order confirmations are not objected to.
1.3	Deviating business terms and conditions of the customer are not binding on us, including where we do not expressly object to them.
1.4	The customer grants us the right to rescind the contract if order performance is impossible as a result of force majeure, strikes, lock-outs, or similar unforeseen events.
1.5	The customer is liable for the accuracy of the documents provided to us, such as drawings, samples, etc.
1.6	Absent our express consent, our documents, such as drawings, samples, etc., may not be made accessible to others. Our express approval is required in order to reprint the content of the catalogue, including excerpts thereof.
1.7	For items offered or promised for delivery from the warehouse, we reserve the ability to make prior sales to others.
1.8	In the event that individual sections of the Business Terms and Conditions are ineffective, or if same are superseded by other agreements, the remaining contractual content remains unaffected thereby and is binding.
1.9	When new price documentation is issued, previous price lists, offers, etc. are no longer valid.
2	Prices
2.1	Unless other agreements were made for a certain delivery, the applicable deliver prices are those on the date of delivery.
2.2	Unless differently worded agreements were made, prices are in € (EUR), net of value-added tax, ex works and excluding packaging. Value-added tax is based on the tax law on the date of delivery. For small orders, a variable surcharge of up to € 30,00 net order value is charged per order.
2.3	Prices are applicable only for the specified normal performance. Deviations in terms of nature, construction, or sizes constitute custom-made products and are charged according to our determinations, including without express designation. Where follow-on orders are placed for custom-made products, no claim can be asserted for previous prices.
2.4	Modifications, special requests and cancellations that are made after contract conclusion may be separately charged in the amount of the incurred costs.
2.5	The customer bears any added costs for express shipment, insurance, etc. where it issued such special instructions.
3	Delivery
3.1	Details concerning delivery times are non-binding. Delivery dates are set by us with the requisite care. They are set by taking into consideration the foreseeable production processes on such date.
3.2	Delivery times begin to run on the date of order confirmation.
3.3	The delivery deadline is extended if unforeseen impediments occur (operational interruptions, delay in delivery by our input suppliers, etc.) that were unable to be avoided despite efforts.
3.4	If the scheduled delivery time, including where extended pursuant to 3.3, is exceeded by more than two months, the customer has the right to rescind the contract after setting a grace period of four weeks.
3.5	Unless expressly agreed otherwise, the customer declares that it is in agreement with partial deliveries and, in the case of custom-made products, with reasonable under- and over-deliveries. Each partial delivery is considered a separate transaction within the meaning of the Business Terms and Conditions.
3.6	Order cancellations and accruals require our written consent. Incurred costs must be reimbursed by the ordering party. Tools may be returned only with our consent. Custom-made products are not taken back. In the case of self-caused returns for credit, a processing fee of € 10,00 per item is charged.
3.7	Shipments are generally dispatched at the customer's risk and expense.
4	Payment Terms
4.1	Our invoices are due and payable within 30 days, net. Repairs are immediately due and payable without deduction.
4.2	Cheques and bills of exchange are not accepted in lieu of payment.
4.3	In the case of default in payment, we are entitled to charge incurred costs and customary bank interest.
4.4	If the customer is in default in payment, we are entitled to withhold outstanding deliveries or to make same against prepayment or cash on delivery. Promised delivery dates may be extended accordingly.
4.5	The buyer may not withhold payments or offset contested counter-claims.
5	Warranty • Liability • Objections to Defects
5.1	We guarantee the delivery of flawless tools, proper performance and steel quality according to the catalogue description. Because of technical progress, we must make reservations for deviations in images, drawings, etc.
5.2	Technical changes and deviations from the catalogue description, image, etc. give the right to complaints only if they constitute an obstacle to the contract purpose. The same also applies to flaws that do not interfere with the intended use of a good.
5.3	Objections must be made within one week of receipt of the goods. The reason for the objection must be described in detail. In the case of flaws that are not immediately discernible, written notice must be given promptly after they become discernible.
5.4	We are not liable for latent defects (e. g. material flaws, etc.) or for defects caused by wear and tear, excessive use, improper handling, unauthorised changes, or improper maintenance.
5.5	For justified objections to defects, we reserve the right to cure or make replacement delivery. Claims of any nature for compensation of damages, including consequential damages, are precluded, other in cases of gross negligence on our part.
6	Retention of Title
6.1	The customer's right to use the goods or to sell them in the normal course of business lapses with the suspension of payments. If the customer is in default in payment, we may revoke this right with respect to the unpaid goods. The purchaser is not permitted to pledge the delivered goods or to assign them for the purposes of security. We must be immediately notified in the event of liens or seizures by a third party. In the event that a good is resold, the purchaser thereupon assigns its claim to us against the acquirer in the amount of the invoice (extended retention of title).
7	Place of Performance • Place of Jurisdiction
7.1	D-73432 Aalen-Niesitz is the place of performance for delivery and payment. The place of jurisdiction is the one with statutory competence over us. Under given circumstances, we reserve the ability to bring suit at the customer's place of jurisdiction. All legal relationships are subject exclusively to German law.



**Reese + Fischer GmbH + Co. KG
NAPOLEON-WERKZEUGE**

Nietheimer Straße 30 • D-73432 Aalen-Niesitz
Phone (+49) 07367 / 96971-0

